

## Disc Brake: 5 Bolt, 4.5" Bolt Circle



- **L68149 Inner / L44649 Outer Bearings**
- Fits #84 Spindle (Most 3,500lb axles)
- Disc Brake Conversion Kits & Service Parts
- Std. Grease & E-Z Lube Applications
- Economical One-Piece Hub/Rotor Design



AXLE  
COMPONENTS

Part No.	Ref. No.	Description
2/HRCM-10KIT*	193125	3.5K 545 Integral (1-piece) Hub/Rotor Disc Kit, 1 axle, Kodiak
ROTOR/HUB-10	193185	10" Integral Hub/Rotor Only, 3.5K 545, Kodiak
2/DBC-225-E	193210	Caliper Set w/pads for 10" & 12" Rotor (1 pair), Kodiak
2/CMB-10-I	193220	Caliper Bkts, 1 pair, for 3.5K w/Integral 10" Hub/Rotor, Kodiak
DBC-225-O-PAD	193211	Disc Brake Pad Kit, fits Dex 3.5K & Kodiak 3.5K-6K (one axle)
L68149	129200	Inner Bearing
L44649	129000	Outer Bearing
L68111	135000	Inner Race
L44610	134400	Outer Race
58846	158800	Grease Seal (2.565" O.D., 1.719" I.D.), Single Lip
10-19	159000	Grease Seal (2.565" O.D., 1.719" I.D.), for E-Z Lube, Double Lip
46749	151200	Grease Cap, 1.986" O.D., Drive-In
21-3-1	151400	Grease Cap, 1.986" O.D., Drive-In, for E-Z Lube
85-1	155400	Grease Cap Plug for E-Z Lube
LB169	144425	Drive-in Stud, 1/2" Dia., 1.69" Long
X1023R	140600	1/2" Cone Wheel Nut

\* Disc Kit includes 2ea Integral Hub/Rotors, 1 pair Calipers w/pads & Brackets for one axle. (Inner/Outer Bearings, Grease Seals, Caps & Wheel Nuts sold separately).

## Disc Brake: 5 Bolt, 4.5" Bolt Circle

- **L68149 Inner / L44649 Outer Bearings**
- Fits Dexter and most other 3,500lb axles
- Complete Disc Conversion Kits & Components
- Std. Grease & E-Z Lube Applications
- Two-Piece Hub/Rotor Design

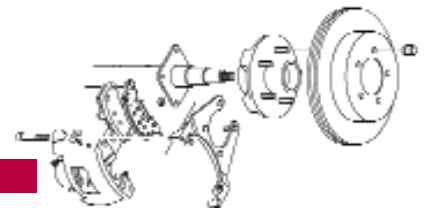

Part No.	Ref. No.	Description
K71-633*	193130	Dex 3.5K Disc Brake Conversion Kit LH
K71-634*	193135	Dex 3.5K Disc Brake Conversion Kit RH
K71-623	193212	Disc Brake Pad Kit, Dex 3.5K (one axle)
DBC-225-O-PAD	193211	Disc Brake Pad Kit, fits Dex 3.5K & Kodiak 3.5K-6K (one axle)
K71-624	193208	LH Caliper w/pads, Dex 3.5K (1 wheel)
K71-625	193209	RH Caliper w/pads, Dex 3.5K (1 wheel)
2/DBC-225-E	193210	Caliper Set w/pads (1 pair), fits Dex 3.5K & Kodiak 3.5K-6K
K71-626	193188	Rotor only, Dex 3.5K (for 2-pc hub/rotor system)
ROTOR-10-E	193187	Rotor only, fits Dex & Kodiak 3.5K (for 2-pc hub/rotor system)
8-248-22	193186	Rep'l Hub Only, 545 for Dexter 3.5K Disc Brake
L68149	129200	Inner Bearing
L44649	129000	Outer Bearing
L68111	135000	Inner Race
L44610	134400	Outer Race
58846	158800	Grease Seal (2.565" O.D., 1.719" I.D.), Single Lip
10-19	159000	Grease Seal (2.565" O.D., 1.719" I.D.), for E-Z Lube, Double Lip
46749	151200	Grease Cap, 1.986" O.D., Drive-In
21-3-1	151400	Grease Cap, 1.986" O.D., Drive-In, for E-Z Lube
85-1	155400	Grease Cap Plug for E-Z Lube
7-150	144800	Drive-in Stud, 1/2" Dia., 2.09" Long



\* Disc Kit includes 1ea 545 hub, rotor, caliper, bracket, inner/outer bearings, grease seal & cap for one side of axle beam. For complete axle conversion, order 1ea K71-633 & 1ea K71-634.

**Disc Brake: 6 Bolt, 5.5" Bolt Circle**

- **25580 Inner / 15123 Outer Bearings**
- Fits Dexter and most other 5,200lb/6,000lb axles
- Disc Brake Conversion Kits & Service Parts
- Std. Grease & E-Z Lube Applications
- Economical One-Piece Hub/Rotor Design



AXLE  
COMPONENTS



Part No.	Ref. No.	Description
2/HRCM-12KIT*	193140	6K 655 Integral (1-piece) Hub/Rotor Disc Kit, 1 axle, Kodiak
ROTOR/HUB-12	193190	12" Integral Hub/Rotor Only, 6K 655 Kodiak
2/DBC-225-E	193210	Caliper Set w/pads for 10" & 12" Rotor (1 pair), Kodiak
2/CMB-12-UA	193225	Caliper Bkts, 1 pair, for 6K w/Integral 12" Hub/Rotor, Kodiak
DBC-225-O-PAD	193211	Disc Brake Pad Kit, fits Dex 3.5K & Kodiak 3.5K-6K (one axle)
25580	130800	Inner Bearing
15123	130400	Outer Bearing
25520	136200	Inner Race
15245	135600	Outer Race
42385	159600	Grease Seal (3.375" O.D., 2.25" I.D.), Single Lip
10-36	159700	Grease Seal (3.375" O.D., 2.25" I.D.), for E-Z Lube, Double Lip
45896	151600	Grease Cap, 2.44" O.D., Drive-In
21-1-1	151800	Grease Cap, 2.44" O.D., Drive-In, for E-Z Lube
85-1	155400	Grease Cap Plug for E-Z Lube
LB2.0	144775	Drive-in Stud, 1/2" Dia., 2.00" Long
X1023R	140600	1/2" Cone Wheel Nut

\* Disc Kit includes 2ea Integral Hub/Rotors, 1 pair Calipers w/pads & Brackets for one axle. (Inner/Outer Bearings, Grease Seals, Caps & Wheel Nuts sold separately).

**Disc Brake: 6 Bolt, 5.5" Bolt Circle**

- **25580 Inner / 15123 Outer Bearings & Nev-R-Lube**
- Fits Dexter and most other 5,200lb/6,000lb axles
- Complete Disc Conversion Kits & Components
- Std. Grease, E-Z Lube & Nev-R-Lube Applications
- Two-Piece Hub/Rotor Design

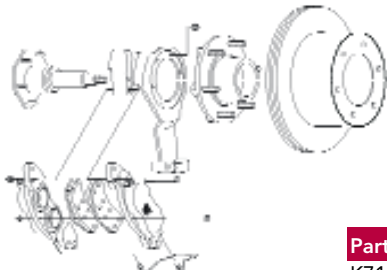

Part No.	Ref. No.	Description
K71-638*	193136	Dex 6K Disc Brake Conversion Kit LH
K71-639*	193137	Dex 6K Disc Brake Conversion Kit RH
K71-629	193217	Rep'l Disc Pad kit, Dex 6K-8K (one axle)
K71-636	193213	Rep'l Caliper, w/Caliper Bolts (1 wheel)
K71-637	193193	Rep'l Disc Rotor, Dex 6K
8-403-5	193191	Rep'l Hub Only, 655 for Dexter 6K Disc Brake
8-404-80	193192	Dexter 6K Disc Nev-R-Lube Hub w/42mm bearing & retainer
31-73-3	130900	Nev-R-Lube Cartridge Bearing, 42mm x 76mm x 39mm
25580	130800	Inner Bearing
15123	130400	Outer Bearing
25520	136200	Inner Race
15245	135600	Outer Race
42385	159600	Grease Seal (3.375" O.D., 2.25" I.D.), Single Lip
10-36	159700	Grease Seal (3.375" O.D., 2.25" I.D.), for E-Z Lube, Double Lip
1609	152600	Grease Cap, 3.125" O.D., Drive-In for Nev-R-Lube
45896	151600	Grease Cap, 2.44" O.D., Drive-In
21-1-1	151800	Grease Cap, 2.44" O.D., Drive-In, for E-Z Lube
85-1	155400	Grease Cap Plug for E-Z Lube
7-150	144800	Drive-in Stud, 1/2" Dia., 2.09" Long
X1023R	140600	1/2" Cone Wheel Nut

\* Disc Kit includes 1ea 655 hub, rotor, caliper, disc pads, bracket, inner/outer bearings, grease seal & cap for one side of axle beam. For complete axle conversion, order 1ea K71-638 & 1ea K71-639.

## Disc Brake: 8 Bolt, 6.5" Bolt Circle



- **25580 Inner / 14125A Outer Bearings**
- Fits Dexter and most other 5,200lb/6,000lb/7,000lb axles
- Disc Brake Conversion Kits & Service Parts
- Std. Grease & E-Z Lube Applications
- Economical One-Piece Hub/Rotor Design
- 1/2" Stud Diameter



AXLE  
COMPONENTS

Part No.	*Ref. No.	Description
2/HRCM-133-7-8-KIT*	193145	7K 865 Integral (1-piece) Hub/Rotor Disc Kit, 1 axle, Kodiak
ROTOR/HUB-133-7-8	193195	13" Integral Hub/Rotor Only, 7K 865 Kodiak
2/DBC-250-E	193215	Caliper Set w/pads for 13" Rotor (1 pair), Kodiak
2/CMB-133-7	193230	Caliper Bkts, 1 pair, for 7K w/Integral 13" Hub/Rotor, Kodiak
DBC-250-SM-PAD	193216	Disc Brake Pad Kit, fits Kodiak 7K-8K (one axle)
25580	130800	Inner Bearing
14125A	130600	Outer Bearing
25520	136200	Inner Race
14276	135800	Outer Race
42385	159600	Grease Seal (3.375" O.D., 2.25" I.D.), Single Lip
10-36	159700	Grease Seal (3.375" O.D., 2.25" I.D.), for E-Z Lube, Double Lip
38605	152200	Grease Cap, 2.72" O.D., Drive-In
21-43-1	152400	Grease Cap, 2.72" O.D., Drive-In, for E-Z Lube
85-1	155400	Grease Cap Plug for E-Z Lube
LB2.0	144775	Drive-in Stud, 1/2" Dia., 2.00" Long
X1023R	140600	1/2" Cone Wheel Nut

\* Disc Kit includes 2ea Integral Hub/Rotors, 1 pair Calipers w/pads & Brackets for one axle. (Inner/Outer Bearings, Grease/Oil Seals & Wheel Nuts sold separately).

## Disc Brake: 8 Bolt, 6.5" Bolt Circle



- **25580 Inner / 02475 Outer Bearings**
- Fits Dexter and most other 8,000lb axles
- Disc Brake Conversion Kits & Service Parts
- Oil Bath or Greased Bearing Lubrication
- Economical One-Piece Hub/Rotor Design
- 9/16" or 5/8" Studs



Part No.	Ref. No.	Description
2/HRCM-133-8-9KIT*	193150	8K 865 Integral Disc Kit, 9/16 Studs, 1 axle, Kodiak
2/HRCM-133-8-10KIT*	193155	8K 865 Integral Disc Kit, 5/8 Studs, 1 axle, Kodiak
ROTOR/HUB-133-8-9**	193200	13" Integral Hub/Rotor Only, 8K 865 9/16" Studs, Kodiak
ROTOR/HUB-133-8-10**	193205	13" Integral Hub/Rotor Only, 8K 865 5/8" Studs, Kodiak
2/DBC-250-E	193215	Caliper Set w/pads for 13" Rotor (1 pair), Kodiak
2/CMB-133-8DI	193235	Caliper Bkts, 1 pair, for 8K w/Integral 13" Hub/Rotor, Kodiak
DBC-250-SM-PAD	193216	Disc Brake Pad Kit, fits Kodiak 7K-8K (one axle)
25580	130800	Inner Bearing
02475	131000	Outer Bearing
25520	136200	Inner Race
02420	137000	Outer Race
10-63	161225	Unitized Oil Seal (3.376" O.D., 2.25" I.D.)
10-36	159700	Grease Seal (3.375" O.D., 2.25" I.D.), for E-Z Lube, Double Lip
RG04-230	150940	Oil Cap Kit (21-35 Cap, 10-45 O-Ring, 46-32 Plug)
LB2.5	145320	Drive-in Stud, 9/16" Dia., 2.50" Long
7-115	145600	Drive-in Stud, 5/8" Dia., 3.16" Long
6-53	140800	9/16" Cone Wheel Nut
6-109	141000	5/8" Cone Wheel Nut
95188	141600	5/8" Flange Wheel Nut

\* Disc Kit includes 2ea Integral Hub/Rotors, 1 pair Calipers w/pads & Brackets for one axle.

\*\* Hub/rotors come w/21-35 oil cap pre-installed, & are suitable for oil bath OR greased bearing lubrication. (Inner/Outer Bearings, Grease/Oil Seals & Wheel Nuts sold separately).

## Disc Brake: 8 Bolt, 6.5" Bolt Circle

AXLE  
COMPONENTS

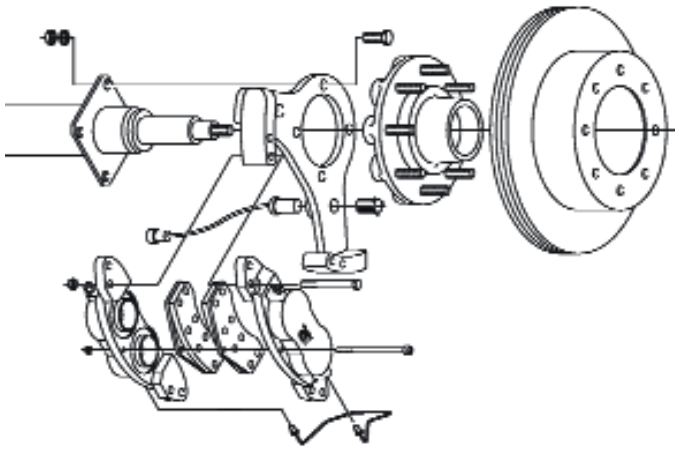

- **25580 Inner / 02475 Outer Bearings & Nev-R-Lube**
- Fits Dexter and most other 8,000lb axles
- Complete Disc Conversion Kits & Components
- Oil Bath, E-Z Lube & Nev-R-Lube Applications
- Two-Piece Hub/Rotor Design
- 9/16" or 5/8" Studs



Part No.	Ref. No.	Description
K71-635*	193160	Dexter 8K Disc Kit, 1 Wheel, less Hub
8-399-90**	193165	Dexter 8K Disc Hub Kit 9/16" Stud, EZ Lube
8-399-91**	193170	Dexter 8K Disc Hub Kit 9/16" Stud, Oil Bath
8-399-92**	193175	Dexter 8K Disc Hub Kit 5/8" Stud, EZ Lube
8-399-93**	193180	Dexter 8K Disc Hub Kit 5/8" Stud, Oil Bath
8-402-80	193182	Dexter 8K Disc Nev-R-Lube Hub w/bearing & retainer, 9/16" Stud
8-402-81	193183	Dexter 8K Disc Nev-R-Lube Hub w/bearing & retainer, 5/8" Stud
K71-630	193218	Rep'l Caliper, w/caliper bolts (1 wheel) 8K
K71-631	193206	Rep'l disc rotor, Dex 8K
K71-629	193217	Rep'l disc pad kit, Dex 6K-8K (one axle)
31-71-3	130875	Nev-R-Lube Cartridge Bearing, 50mm x 84mm x 54mm
25580	130800	Inner Bearing
02475	131000	Outer Bearing
25520	136200	Inner Race
02420	137000	Outer Race
10-63	161225	Unitized Oil Seal (3.376" O.D., 2.25" I.D.)
10-36	159700	Grease Seal (3.376" O.D., 2.25" I.D.), for E-Z Lube, Double Lip
21-43-1	152400	Grease Cap, 2.72" O.D., Drive-In, for E-Z Lube
85-1	155400	Grease Cap Plug for E-Z Lube
RG04-230	150940	Oil Cap Kit (21-35 Cap, 10-45 O-Ring, 46-32 Plug)
7-257	145310	Drive-in Stud, 9/16" Dia., 2.50" Long
7-115	145600	Drive-in Stud, 5/8" Dia., 3.16" Long
6-53	140800	9/16" Cone Wheel Nut
6-109	141000	5/8" Cone Wheel Nut
95188	141600	5/8" Flange Wheel Nut

\* Disc Kit includes 1ea 8K rotor, caliper, disc pads, bracket, & hardware for std grease or E-Z-Lube axle conversions to one side of axle beam.

\*\* Disc hub kits include inner/outer bearing, seal & dust cap.