

Replacement Hub and Drum Assemblies

4 Bolt, 4" Bolt Circle

AXLE
COMPONENTS

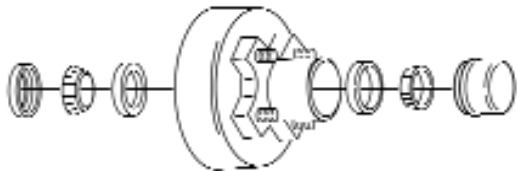

- **L44643 Inner / Outer Bearings**
- Capacity of 1,250 lbs. per each
- Fits BT8 1" spindle
- Drum size: 7" x 1 3/4"



| Part No. | Ref. No. | Description |
|-----------|----------|--|
| HD700AUC3 | 115000 | Complete Hub and Drum Assembly |
| HD700A | 114800 | Hub and Drum Only |
| L44643 | 128800 | Inner / Outer Bearing |
| L44610 | 134400 | Inner / Outer Race |
| 34823 | 157800 | Grease Seal (1.983" O. D., 1.249" I.D.), Single Lip |
| 12192TB | 157805 | Grease Seal (1.983" O. D., 1.249" I.D.), Double Lip "Optional" |
| 46749 | 151200 | Grease Cap, 1.986" O.D., Drive-in |
| 25-53 | 147800 | Screw-in Stud, 1/2" Diameter |
| X1023R | 140600 | 1/2" Cone Wheel Nut |

4 Bolt, 4" Bolt Circle

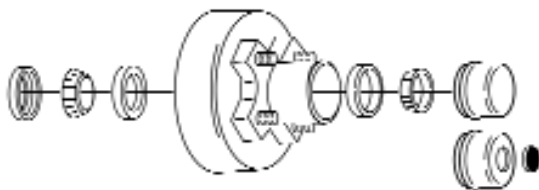

- **L44649 Inner / Outer Bearings**
- Fits Dexter 2,000 lb. axle
- BTR 1 1/16" Spindle
- Std. Grease or E-Z Lube application
- Drum Size: 7" x 1 3/4"



| Part No. | Ref. No. | Description |
|--------------|----------|--|
| HD701BUC3 | 115400 | Complete Hub and Drum Assembly |
| HD701BUC3-EZ | 115425 | Complete E-Z Lube Hub and Drum Assembly |
| HD700A | 114800 | Hub and Drum Only |
| L44649 | 129000 | Inner / Outer Bearing |
| L44610 | 134400 | Inner / Outer Race |
| 10-9 | 158000 | Grease Seal (1.987" O. D., 1.5" I.D.), Single Lip |
| 10-60 | 158200 | Grease Seal (1.987" O. D., 1.5" I.D.) for E-Z Lube, Double Lip |
| 46749 | 151200 | Grease Cap, 1.986" O.D., Drive-in |
| 21-3-1 | 151400 | Grease Cap, 1.986" O.D., Drive-in, for E-Z Lube |
| 85-1 | 155400 | Grease Cap Plug for E-Z Lube |
| 25-53 | 147800 | Screw-in Stud, 1/2" Diameter |
| X1023R | 140600 | 1/2" Cone Wheel Nut |

4 Bolt, 9.4" Bolt Circle

- Fits #84 Spindle, L68149 Inner / L44649 Outer Bearings
- Capacity of 1,750 lbs. per each
- Available in Std. Grease or E-Z Lube Application
- Drum Size: 10" x 2 1/4"

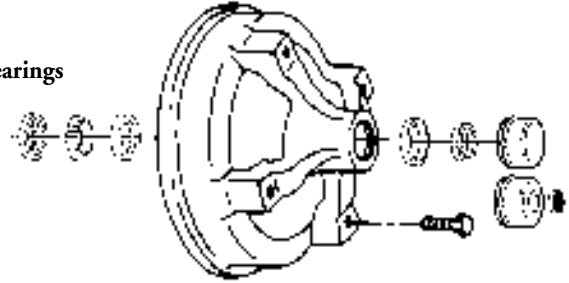

AXLE
COMPONENTS

| Part No. | Ref. No. | Description |
|---------------|----------|--|
| 8-245-4UC3 | 118600 | Complete Hub and Drum Assembly |
| 8-245-4UC3-EZ | 118625 | Complete E-Z Lube Hub and Drum Assembly |
| 8-245-4 | 118400 | Hub and Drum Only |
| L68149 | 129200 | Inner Bearing |
| L44649 | 129000 | Outer Bearing |
| L68111 | 135000 | Inner Race |
| L44610 | 134400 | Outer Race |
| 58846 | 158800 | Grease Seal (2.565" O. D., 1.719" I.D.), Single Lip |
| 10-19 | 159000 | Grease Seal (2.565" O. D., 1.719" I.D.) for E-Z Lube, Double Lip |
| 46749 | 151200 | Grease Cap, 1.986" O.D., Drive-in |
| 21-3-1 | 151400 | Grease Cap, 1.986" O.D., Drive-in, for E-Z Lube |
| 85-1 | 155400 | Grease Cap Plug for E-Z Lube |
| X1064 | 143200 | Wheel Bolt, 1/2" Diameter |



4 Bolt, 9.4" Bolt Circle

- Fits Dexter 5,200 lb. and 6,000 lb. axles,
25580 Inner / LM67048 Outer Bearings
- Capacity of 3,000 lbs. per each
- Available in Std. Grease or E-Z Lube Application
- Drum Size: 12" x 2"

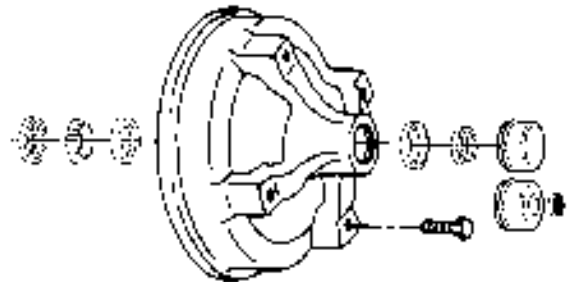

| Part No. | Ref. No. | Description |
|---------------|----------|--|
| 8-155-4UC3 | 120600 | Complete Hub and Drum Assembly |
| 8-155-4UC3-EZ | 120625 | Complete E-Z Lube Hub and Drum Assembly |
| 8-155-4 | 120400 | Hub and Drum Only |
| 25580 | 130800 | Inner Bearing |
| LM67048 | 130000 | Outer Bearing |
| 25520 | 136200 | Inner Race |
| LM67010 | 136200 | Outer Race |
| 10-1 | 159800 | Grease Seal (3.376" O. D., 2.125" I.D.), Single Lip |
| 10-10 | 160000 | Grease Seal (3.376" O. D., 2.125" I.D.) for E-Z Lube, Double Lip |
| 45896 | 151600 | Grease Cap, 2.44" O.D., Drive-in |
| 21-1-1 | 151800 | Grease Cap, 2.44" O.D., Drive-in, for E-Z Lube |
| 85-1 | 155400 | Grease Cap Plug for E-Z Lube |
| X1064 | 143200 | Wheel Bolt, 1/2" Diameter |



5 Bolt, 4.5" Bolt Circle

AXLE
COMPONENTS

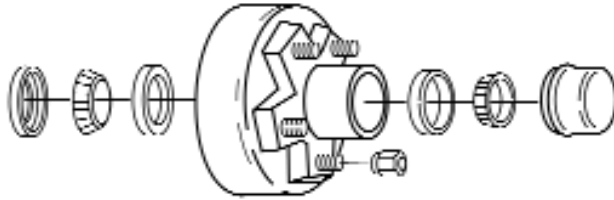

- Fits BT8 1" Spindle, L44643 Inner / Outer Bearings
- Capacity of 1,250 lbs. per each
- Drum Size: 7" x 1 3/4"

| Part No. | Ref. No. | Description |
|-----------|----------|--|
| HD702CUC3 | 115800 | Complete Hub and Drum Assembly |
| HD702C | 115600 | Hub and Drum Only |
| L44643 | 128800 | Inner / Outer Bearing |
| L44610 | 134400 | Inner / Outer Race |
| 34823 | 157800 | Grease Seal (1.983" O. D., 1.249" I.D.), Single Lip |
| 12192TB | 157805 | Grease Seal (1.983" O. D., 1.249" I.D.), Double Lip "Optional" |
| 46749 | 151200 | Grease Cap, 1.986" O.D., Drive-in |
| 25-53 | 147800 | Screw-in Stud, 1/2" Diameter |
| X1023R | 140600 | 1/2" Cone Wheel Nut |

5 Bolt, 4.5" Bolt Circle

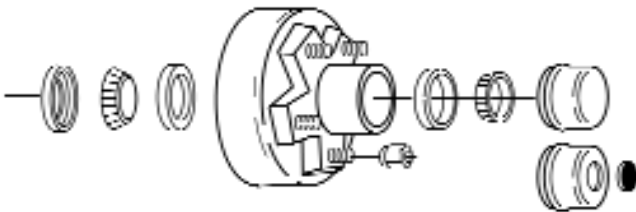

- Fits Dexter 2,000 lb. axle, 1 1/16" spindle, L44649 Inner / Outer Bearings
- Available in Standard or E-Z Lube application
- Drum Size: 7" x 1 3/4"



| Part No. | Ref. No. | Description |
|--------------|----------|--|
| HD703DUC3 | 116200 | Complete Hub and Drum Assembly |
| HD703DUC3-EZ | 116225 | Complete E-Z Lube Hub and Drum Assembly |
| HD702C | 115600 | Hub and Drum Only |
| L44649 | 129000 | Inner / Outer Bearing |
| L44610 | 134400 | Inner / Outer Race |
| 10-9 | 158000 | Grease Seal (1.987" O. D., 1.5" I.D.), Single Lip |
| 10-60 | 158200 | Grease Seal (1.987" O. D., 1.5" I.D.) for E-Z Lube, Double Lip |
| 46749 | 151200 | Grease Cap, 1.986" O.D., Drive-in |
| 21-3-1 | 151400 | Grease Cap, 1.986" O.D., Drive-in, for E-Z Lube |
| 85-1 | 155400 | Grease Cap Plug for E-Z Lube |
| 25-53 | 147800 | Screw-in Stud, 1/2" Diameter |
| X1023R | 140600 | 1/2" Cone Wheel Nut |

5 Bolt, 4.5", 4.75", 5", 5.5" Bolt Circle

- Fits #84 Spindle, L68149 Inner / L44649 Outer Bearings.
- Capacity of 1,750 lbs. per each
- Available in Standard or E-Z Lube Application
- Used on Dexter and most 3,500 lb axles
- Drum Size: 10" x 2 1/4"
- 4 Different Bolt Patterns

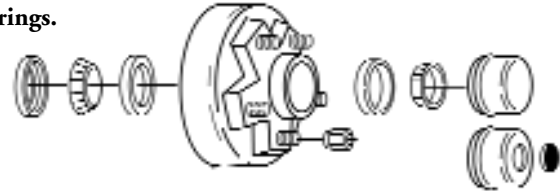

AXLE
COMPONENTS

| Part No. | Ref. No. | Description |
|--------------|----------|--|
| 84546UC3 | 116600 | Complete Hub and Drum Assembly, 4.5" Bolt Circle |
| 84546UC3-EZ | 116625 | Complete E-Z Lube Hub and Drum Assembly, 4.5" Bolt Circle |
| 84546 | 116400 | Hub and Drum Only, 4.5" Bolt Circle |
| 845476UC3 | 117000 | Complete Hub and Drum Assembly, 4.75" Bolt Circle |
| 845476UC3-EZ | 117025 | Complete E-Z Lube Hub and Drum Assembly, 4.75" Bolt Circle |
| 845476 | 116800 | Hub and Drum Only, 4.75" Bolt Circle |
| 84556UC3 | 117400 | Complete Hub and Drum Assembly, 5" Bolt Circle |
| 84556UC3-EZ | 117425 | Complete E-Z Lube Hub and Drum Assembly, 5" Bolt Circle |
| 84556 | 117200 | Hub and Drum Only, 5" Bolt Circle |
| 84557UC3 | 117800 | Complete Hub and Drum Assembly, 5.5" Bolt Circle |
| 84557UC3-EZ | 117825 | Complete E-Z Lube Hub and Drum Assembly, 5.5" Bolt Circle |
| 84557 | 117600 | Hub and Drum Only, 5.5" Bolt Circle |
| L68149 | 129200 | Inner Bearing |
| L44649 | 129000 | Outer Bearing |
| L68111 | 135000 | Inner Race |
| L44610 | 134400 | Outer Race |
| 58846 | 158800 | Grease Seal (2.565" O. D., 1.719" I.D.), Single Lip |
| 10-19 | 159000 | Grease Seal (2.565" O. D., 1.719" I.D.) for E-Z Lube, Double Lip |
| 46749 | 151200 | Grease Cap, 1.986" O.D., Drive-in |
| 21-3-1 | 151400 | Grease Cap, 1.986" O.D., Drive-in, for E-Z Lube |
| 85-1 | 155400 | Grease Cap Plug for E-Z Lube |
| 7-122 | 144600 | Drive-in Stud, 1/2" Diameter |
| X1023R | 140600 | 1/2" Cone Wheel Nut |



6 Bolt, 5.5" Bolt Circle

- Fits #84 Spindle, L68149 Inner / L44649 Outer Bearings
- Capacity of 1,750 lbs. per each
- Available in Standard or E-Z Lube Application
- Used on Dexter and most 3,500 lb. Axles
- Drum Size: 10" x 2 1/4"



| Part No. | Ref. No. | Description |
|-------------|----------|---|
| 84656UC3 | 118200 | Complete Hub and Drum Assembly |
| 84656UC3-EZ | 118225 | Complete E-Z Lube Hub and Drum Assembly |
| 84656 | 118000 | Hub and Drum Only |



Components for this hub are the same as listed in the table above

6 Bolt, 5.5" Bolt Circle



- Fits Dexter 5,200 lb. and 6,000 lb. Axles, #42 Spindle, 25580 Inner / 15123 Outer Bearings
- Capacity of 3,000 lbs. per each
- For Spindles requiring a 2 1/8" or 2 1/4" I.D. Grease Seal
- Drum Size: 12" x 2"



| Part No. | Ref. No. | Description |
|---------------|----------|--|
| 42656UC3 | 119000 | Complete Hub and Drum Assembly w/ 2 1/4" I.D. Seal |
| 42656UC3-EZ | 119050 | Complete E-Z Lube Hub and Drum Assembly w/ 2 1/4" I.D. Seal |
| 8-201-9UC3 | 119100 | Complete Hub and Drum Assembly w/ 2 1/8" I.D. Seal |
| 8-201-9UC3-EZ | 119150 | Complete E-Z Lube Hub and Drum Assembly w/ 2 1/8" I.D. Seal |
| 42656 | 118800 | Hub and Drum Only |
| 25580 | 130800 | Inner Bearing |
| 15123 | 130400 | Outer Bearing |
| 25520 | 136200 | Inner Race |
| 15245 | 135600 | Outer Race |
| 42385 | 159600 | Grease Seal (3.376" O. D., 2.25" I.D.), Single Lip |
| 10-36 | 159700 | Grease Seal (3.376" O. D., 2.25" I.D.), for E-Z Lube, Double Lip |
| 10-1 | 159800 | Grease Seal (3.376" O.D., 2.125" I.D.), Single Lip |
| 10-10 | 160000 | Grease Seal (3.376" O.D., 2.125" I.D.), for E-Z Lube, Double Lip |
| 45896 | 151600 | Grease Cap, 2.44" O.D., Drive-in |
| 21-1-1 | 151800 | Grease Cap, 2.44" O.D., Drive-in, for E-Z Lube |
| 85-1 | 155400 | Grease Cap Plug for E-Z Lube |
| 7-122 | 144600 | Drive-in Stud, 1/2" Dia. x 1-13/16" long |
| 165995 | 145000 | Drive-in Stud, 1/2" Dia. x 2-1/2" long |
| X1023R | 140600 | 1/2" Cone Wheel Nut |

6 Bolt, 5.5" Bolt Circle



- Fits Dexter 5,200 lb. and 6,000 lb. Axles, 25580 Inner / LM67048 Outer Bearings
- Capacity of 3,000 lbs. per each
- Available in Standard or E-Z Lube application
- Drum Size: 12" x 2"



| Part No. | Ref. No. | Description |
|---------------|----------|--|
| 8-201-5UC3 | 119400 | Complete Hub and Drum Assembly |
| 8-201-5UC3-EZ | 119425 | Complete E-Z Lube Hub and Drum Assembly |
| 8-201-5 | 119200 | Hub and Drum only |
| 25580 | 130800 | Inner Bearing |
| LM67048 | 130000 | Outer Bearing |
| 25520 | 136200 | Inner Race |
| LM67010 | 135400 | Outer Race |
| 10-1 | 159800 | Grease Seal (3.376" O.D., 2.125" I.D.), Single Lip |
| 10-10 | 160000 | Grease Seal (3.376" O.D., 2.125" I.D.), for E-Z Lube, Double Lip |
| 45896 | 151600 | Grease Cap, 2.44" O.D., Drive-in |
| 21-1-1 | 151800 | Grease Cap, 2.44" O.D., Drive-in, for E-Z Lube |
| 85-1 | 155400 | Grease Cap Plug for E-Z Lube |
| 7-122 | 144600 | Drive-in Stud, 1/2" Dia. x 1-13/16" long |
| 165995 | 145000 | Drive-in Stud, 1/2" Dia. x 2-1/2" long |
| X1023R | 140600 | 1/2" Cone Wheel Nut |

5 Spoke, Utility Type (Grease & Oil)

- Fits Dexter 6,000 lb. and 7,000 lb. Axles,
25580 Inner / 15123 Outer Bearings
- Capacity of 3,500 lbs. per each
- Drum Size: 12" x 2"
- For spindles requiring 2 1/8" or 2 1/4" I.D. Seals
- Std. Grease, E-Z Lube or Oil Bath Application



AXLE
COMPONENTS

| Part No. | Ref. No. | Description |
|------------------|----------|---|
| 8-174-5UC3 | 121000 | Complete Hub and Drum Assembly, Grease - 2 1/8" I.D. Seal |
| 8-174-5UC3-EZ | 121010 | Complete E-Z Lube Hub and Drum Assembly, Grease, 2 1/8" I.D. Seal |
| 8-174-5UC3-225 | 121015 | Complete Hub and Drum Assembly, Grease - 2 1/4" I.D. Seal |
| 8-174-5UC3EZ-225 | 121020 | Complete E-Z Lube Hub and Drum Assembly, Grease - 2 1/4" I.D. Seal |
| 8-174-5 | 120800 | Hub and Drum Only, Grease |
| 8-174-6UC3 | 121050 | Complete Oil Bath Hub and Drum Assembly, 2 1/8" I.D. Seal |
| 8-174-6UC3-225 | 121055 | Complete Oil Bath Hub and Drum Assembly, 2 1/4" I.D. Seal |
| 8-174-6 | 121025 | Hub and Drum Only, Oil Bath |
| 25580 | 130800 | Inner Bearing |
| 15123 | 130400 | Outer Bearing |
| 25520 | 136200 | Inner Race |
| 15245 | 135600 | Outer Race |
| 42385 | 159600 | Grease Seal (3.376" O.D., 2.250" I.D.), Single Lip |
| 10-36 | 159700 | Grease Seal (3.376" O.D., 2.250" I.D.), for E-Z Lube, Double Lip |
| 10-1 | 159800 | Grease Seal (3.376" O.D., 2.125" I.D.), Single Lip |
| 10-10 | 160000 | Grease Seal (3.376" O.D., 2.125" I.D.), for E-Z Lube & Oil Bath, Double Lip |
| 10-63 | 161225 | Oil Seal, (3.376" O.D., 2.250" I.D.), Unitized |
| 45896 | 151600 | Grease Cap, 2.44" O.D., Drive-in |
| 21-1-1 | 151800 | Grease Cap, 2.44" O.D., Drive-in, for E-Z Lube |
| 85-1 | 155400 | Grease Cap Plug for E-Z Lube |
| RG04-260 | 150950 | Oil Cap Kit, (21-40 Cap, 10-59 O-Ring) |
| 10-59 | 156825 | O-Ring Gasket for 21-40 Oil Cap |
| 46-52 | 156000 | Oil Hub Plug |
| 15-2 | 149600 | Rim Clamp |
| 25-11 | 148200 | Screw-in Stud, 9/16" Diameter |
| 916N | 078400 | 9/16" Wheel Nut |



8 Bolt, 6.5" Bolt Circle

- Fits #99 Spindle,
28580 Inner, 25580 Outer Bearing
- Drum Size: 12" x 2"

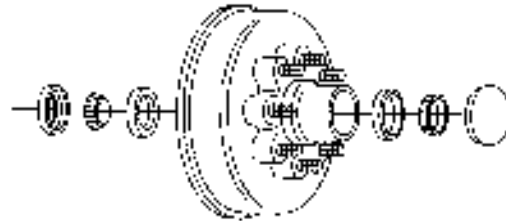

| Part No. | Ref. No. | Description |
|----------|----------|--|
| 99865UC3 | 121400 | Complete Hub and Drum Assembly |
| 99865 | 121200 | Hub and Drum Only |
| 28580 | 132200 | Inner Bearing |
| 25580 | 130800 | Outer Bearing |
| 28521 | 136800 | Inner Race |
| 25520 | 136200 | Outer Race |
| T51153 | 160200 | Grease Seal (3.623" O.D., 2.375" I.D.), Single Lip |
| 75DC | 153000 | Grease Cap, 3.375" O.D., Drive-in |
| 165995 | 145000 | Drive-in Stud, 1/2" Diameter |
| X1023R | 140600 | 1/2" Cone Wheel Nut |

8 Bolt, 6.5" Bolt Circle

AXLE
COMPONENTS

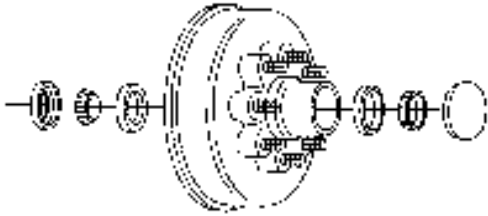

- Fits Dexter 5,200 lb. thru 7,000 lb. Axles
- #42 Spindle, 25580 Inner / 14125A Outer Bearings
- Capacity of 3,500 lbs. per each
- For Spindles Requiring 2 1/4" or 2 1/8" I.D. Seal
- Drum Size 12" x 2"
- Available in Standard, E-Z Lube or Oil Bath applications

| Part No. | Ref. No. | Description |
|---------------|----------|--|
| 42866UC3 | 119800 | Complete Hub and Drum Assembly w/ 2 1/4" I.D. Seal |
| 42866UC3-EZ | 119810 | Complete E-Z Lube Hub and Drum Assembly w/ 2 1/4" I.D. Seal |
| 8-219-4UC3 | 120200 | Complete Hub and Drum Assembly w/ 2 1/8" I.D. Seal |
| 8-219-4UC3-EZ | 120225 | Complete E-Z Lube Hub and Drum Assembly w/ 2 1/8" I.D. Seal |
| 42866 | 119600 | Hub and Drum Only, Grease/EZ Lube |
| 8-219-9UC3 | 120275 | Complete Oil Bath Hub and Drum Assembly w/ 2 1/8" I.D. Seal |
| 8-219-9UC3A | 120280 | Complete Oil Bath Hub and Drum Assembly w/ 2 1/4" I.D. Seal |
| 8-219-9 | 120250 | Hub and Drum Only, Oil Bath |
| 25580 | 130800 | Inner Bearing |
| 14125A | 130600 | Outer Bearing |
| 25520 | 136200 | Inner Race |
| 14276 | 135800 | Outer Race |
| 42385 | 159600 | Grease Seal (3.376" O.D., 2.25" I.D.), Single Lip |
| 10-36 | 159700 | Grease Seal (3.376" O.D., 2.25" I.D.), for E-Z Lube, Double Lip |
| 10-1 | 159800 | Grease Seal (3.376" O.D., 2.125" I.D.), Single Lip |
| 10-10 | 160000 | Seal (3.376" O.D., 2.125" I.D.), for E-Z Lube & Oil Bath, Double Lip |
| 10-63 | 161225 | Unitized Oil Seal (3.376" O.D., 2.25" I.D.) |
| 38605 | 152200 | Grease Cap, 2.72" O.D., Drive-in |
| 21-43-1 | 152400 | Grease Cap for E-Z Lube |
| 85-1 | 155400 | Grease Cap Plug for E-Z Lube |
| RG04-230 | 150940 | Oil Cap Kit, (21-25 Cap, 10-45 O-Ring, 46-32 Plug) |
| 46-52 | 156000 | Oil Hub Plug |
| 7-122 | 144600 | Drive-in Stud, 1/2" Dia. x 1-13/16" long |
| 165995 | 145000 | Drive-in Stud, 1/2" Dia. x 2-1/2" long |
| X1023R | 140600 | 1/2" Cone Wheel Nut |



8 Bolt, 6.5" Bolt Circle

- Fits Dexter 7,200 lb. Axles, 25580 Inner / 02475 Outer Bearings
- Oil Bath, Grease or E-Z Lube
- Hub comes with $\frac{9}{16}$ " or $\frac{5}{8}$ " studs
- Drum Size: 12 $\frac{1}{4}$ " x 2 $\frac{1}{2}$ "

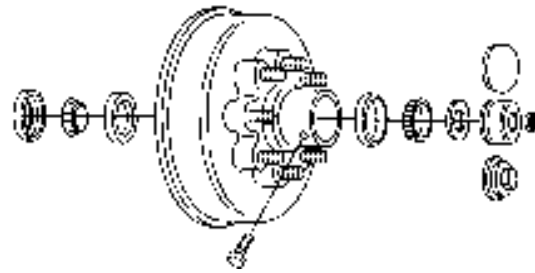

In February 2000, the 7,200 lb. axle was upgraded from a 9-bolt to a 4-bolt brake flange. Be sure to verify flange type before making your selection, hub/drums will not interchange.

| Part No. | Ref. No. | Description |
|-----------------|----------|--|
| 8-355-12 | 122355 | Hub & drum only, oil bath, 9/16" stud (9-bolt flange) |
| 8-355-12UC3 | 122360 | Complete hub & drum assembly, oil bath, 9/16" stud (9-bolt flange) |
| 8-393-3 | 122361 | Hub & drum only, oil bath, 9/16" stud (4-bolt flange) |
| 8-393-3UC3 | 122362 | Complete hub & drum assembly, oil bath, 9/16" stud (4-bolt flange) |
| 8-355-13 | 122363 | Hub & drum only, grease, 9/16" stud (9-bolt flange) |
| 8-355-13UC3 | 122365 | Complete hub & drum assembly, grease, 9/16" stud (9-bolt flange) |
| 8-355-13UC3-EZ | 122370 | Complete EZ Lube hub & drum assembly, grease, 9/16" stud (9-bolt flange) |
| 8-393-4 | 122375 | Hub & drum only, grease, 9/16" stud (4-bolt flange) |
| 8-393-4UC3 | 122377 | Complete hub & drum assembly, grease, 9/16" stud (4-bolt flange) |
| 8-393-4UC3-EZ | 122380 | Complete EZ Lube hub & drum assembly, grease, 9/16" stud (4-bolt flange) |
| 8-355-14 | 122425 | Hub & drum only, oil bath, 5/8" stud (9-bolt flange) |
| 8-355-14UC3-A | 122430 | Complete hub & drum assembly, oil bath, 5/8" flg nuts (9-bolt flange) |
| 8-355-14UC3-B | 122435 | Complete hub & drum assembly, oil bath, 5/8" cone nuts (9-bolt flange) |
| 8-393-5 | 122436 | Hub & drum only, oil bath, 5/8" stud (4-bolt flange) |
| 8-393-5UC3-A | 122437 | Complete hub & drum assembly, oil bath, 5/8" flg nuts (4-bolt flange) |
| 8-393-5UC3-B | 122438 | Complete hub & drum assembly, oil bath, 5/8" cone nuts (4-bolt flange) |
| 8-355-15 | 122440 | Hub & drum only, grease, 5/8" stud (9-bolt flange) |
| 8-355-15UC3-A | 122445 | Complete hub & drum assembly, grease, 5/8" flg nuts (9-bolt flange) |
| 8-355-15UC3-B | 122450 | Complete hub & drum assembly, grease, 5/8" cone nuts (9-bolt flange) |
| 8-355-15UC3-EZA | 122455 | Complete EZ Lube hub & drum assembly, grease, 5/8" flg nuts (9-bolt flange) |
| 8-355-15UC3-EZB | 122460 | Complete EZ Lube hub & drum assembly, grease, 5/8" cone nuts (9-bolt flange) |
| 8-393-6 | 122462 | Hub & drum only, grease, 5/8" stud (4-bolt flange) |
| 8-393-6UC3-A | 122463 | Complete hub & drum assembly, grease, 5/8" flg nuts (4-bolt flange) |
| 8-393-6UC3-B | 122464 | Complete hub & drum assembly, grease, 5/8" cone nuts (4-bolt flange) |
| 8-393-6UC3-EZA | 122465 | Complete EZ Lube hub & drum assembly, grease, 5/8" flg nuts (4-bolt flange) |
| 8-393-6UC3-EZB | 122466 | Complete EZ Lube hub & drum assembly, grease, 5/8" cone nuts (4-bolt flange) |
| 25580 | 130800 | Inner Bearing |
| 02475 | 131000 | Outer Bearing |
| 10-63 | 161225 | Unitized Oil Seal (3.376" O.D., 2.250" I.D.) |
| 21-43-1 | 152400 | Grease Cap, 2.72" O.D. Drive-in for E-Z Lube |
| 38605 | 152200 | Grease Cap, 2.72" O.D. Drive-in |
| RG04-230 | 150940 | Oil Cap Kit, (21-35 Cap, 10-45 O-Ring, 46-32 Plug) |
| 85-1 | 155400 | Grease Cap Plug, For All E-Z Lube Grease Caps |
| 7-223 | 145300 | Drive-in Stud, 9/16" Diameter |
| 7-224 | 145350 | Drive-in Stud, 5/8" Diameter |
| 6-53 | 140800 | 9/16" Cone Wheel Nut |
| 6-109 | 141000 | 5/8" Cone Wheel Nut |
| 95188 | 141600 | 5/8" Flange Wheel Nut |



8 Bolt, 6.5" Bolt Circle

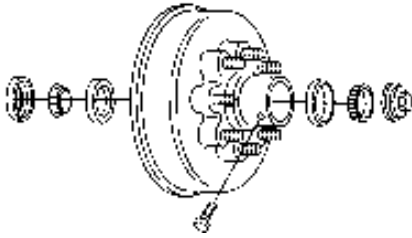

- Fits Dexter 7,500 lb. Axles, 25580 Inner / 02475 Outer Bearings
- Oil Bath Hub and Drum, 5/8" Stud
- Drum Size: 12" x 3"



| Part No. | Ref. No. | Description |
|------------|----------|--|
| 8-187-7UC3 | 122200 | Complete Hub and Drum Assembly |
| 8-187-7 | 122000 | Hub and Drum Only |
| 25580 | 130800 | Inner Bearing |
| 02475 | 131000 | Outer Bearing |
| 25520 | 136200 | Inner Race |
| 02420 | 137000 | Outer Race |
| 10-63 | 161225 | Unitized Oil Seal (3.376" O.D., 2.250" I.D.) |
| RG04-230 | 150940 | Oil Cap Kit, (21-35 Cap, 10-45 O-Ring, 46-32 Plug) |
| 46-52 | 156000 | Oil Hub Plug |
| 25-48 | 148800 | Screw-in Stud, 5/8" Diameter |
| 6-109 | 141000 | 5/8" Cone Wheel Nut |

8 Bolt, 6.5" Bolt Circle

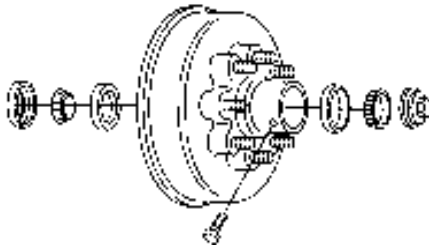

- Fits Hayes 8,000 lb. Axles, 25580 Inner / 02475 Outer Bearings
- Drum Size: 12" x 3 1/4"
- Oil Bath Hub & Drum

| Part No. | Ref. No. | Description |
|------------|----------|---|
| 9080648UC3 | 122325 | Complete Hub and Drum Assembly |
| 9080648 | 122300 | Hub and Drum Only |
| 25580 | 130800 | Inner Bearing |
| 02475 | 131000 | Outer Bearing |
| 25520 | 136200 | Inner Race |
| 02420 | 137000 | Outer Race |
| RG04-280 | 150960 | Oil Cap Kit, (New Style, after 01/97), (92128 Cap, 9103501 Gasket, 92126 Plug) |
| RG04-290 | 150965 | Oil Cap Kit, (Old Style, before 01/97), (9212801 Cap, 9103501 Gasket, 92126 Plug) |
| 10-63 | 161225 | Unitized Oil Seal, 3.376" O.D., 2.250" I.D. |
| 6-53 | 140800 | 9/16" Cone Wheel Nut |

8 Bolt, 6.5" Bolt Circle

- Fits Dexter 8,000 lb. Axles, 25580 Inner / 02475 Outer Bearings
- Oil Bath or E-Z Lube
- Hub comes with 9/16" or 5/8" studs
- 4.56" (Old Style) or 4.75" (New Style) Hub Pilot
- Drum Size: 12 1/4" x 3 3/8"
- Available with or without ABS exciter ring installed.



COMPONENTS
AXLE

| Standard Hub / Drums | | | ABS Hubs / Drums | |
|----------------------|----------|--|------------------|---------|
| Part No. | Ref. No. | Description | Part No. | Ref No. |
| 8-218-9 | 122575 | Hub and Drum Only (4.56" Pilot) Oil Bath - 9/16" Studs | N/A | N/A |
| 8-218-9UC3 | 122600 | Complete Hub and Drum Assembly (4.56" Pilot) Oil Bath - 9/16" Studs | N/A | N/A |
| 8-285-8 | 123010 | Hub and Drum Only, (4.75" Pilot) E-Z Lube - 5/8" Studs | 8-285-15 | 123096 |
| 8-285-8UC3-A | 123015 | Complete Hub and Drum Assembly (4.75" Pilot) E-Z Lube - 5/8" Studs & 95188 Nut | 8-285-15UC3-A | 123098 |
| 8-285-8UC3-B | 123020 | Complete Hub and Drum Assembly (4.75" Pilot) E-Z Lube - 5/8" Studs & 6-109 Nut | 8-285-15UC3-B | 123099 |
| 8-285-9 | 123025 | Hub and Drum Only (4.75" Pilot) Oil Bath - 9/16" Studs | 8-285-12 | 123082 |
| 8-285-9UC3 | 123050 | Complete Hub and Drum Assembly (4.75" Pilot) Oil Bath - 9/16" Studs | 8-285-12UC3 | 123084 |
| 8-285-10 | 123055 | Hub and Drum Only, (4.75" Pilot), Oil Bath - 5/8" Studs | 8-285-14 | 123090 |
| 8-285-10UC3-A | 123060 | Complete Hub and Drum Assembly (4.75" Pilot) Oil Bath - 5/8" Studs & 95188 Nut | 8-285-14UC3-A | 123092 |
| 8-285-10UC3-B | 123065 | Complete Hub and Drum Assembly (4.75" Pilot) Oil Bath - 5/8" Studs & 6-109 Nut | 8-285-14UC3-B | 123094 |
| 8-285-11 | 123075 | Hub and Drum Only (4.75" Pilot) E-Z Lube - 9/16" Studs | 8-285-13 | 123086 |
| 8-285-11UC3 | 123080 | Complete Hub and Drum Assembly (4.75" Pilot) E-Z Lube 9/16" Studs | 8-285-13UC3 | 123088 |



Replacement Components

| Part No. | Ref. No. | Description |
|----------|----------|--|
| 25580 | 130800 | Inner Bearing |
| 02475 | 131000 | Outer Bearing |
| 25520 | 136200 | Inner Race |
| 02420 | 137000 | Outer Race |
| 10-63 | 161225 | Unitized Oil Seal (3.376" O.D., 2.250" I.D.) |
| 10-36 | 159700 | Grease Seal, Double Lip, (3.376" O.D., 2.25" I.D.), for E-Z Lube |
| 21-43-1 | 152400 | Grease Cap, 2.72" O.D. Drive-in for E-Z Lube |
| 85-1 | 155400 | Grease Cap Plug, for All E-Z Lube Grease Caps |
| RG04-230 | 150940 | Oil Cap Kit, (21-35 Cap, 10-45 O-Ring, 46-32 Plug) |
| 46-52 | 156000 | Oil Hub Plug |
| 7-132 | 145200 | Drive-in Stud, 9/16" Diameter |
| 7-232 | 145400 | Drive-in Stud, 5/8" Diameter |
| 6-53 | 140800 | 9/16" Cone Wheel Nut |
| 6-109 | 141000 | 5/8" Cone Wheel Nut |
| 95188 | 141600 | 5/8" Flange Wheel Nut |

8 Bolt, 6.5" Bolt Circle

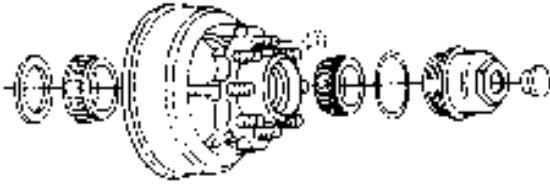

- Fits #99 Spindle, 28580 Inner / 25580 Outer Bearings
- Oil Bath Hub (Dual Wheel)
- Drum Size: 12 1/4" x 3 1/2"

| Part No. | Ref. No. | Description |
|------------|----------|--|
| 9080568UC3 | 121800 | Complete Hub and Drum Assembly |
| 9080568 | 121600 | Hub and Drum Only |
| 28580 | 132200 | Inner Bearing |
| 25580 | 130800 | Outer Bearing |
| 28521 | 136800 | Inner Race |
| 25520 | 136200 | Outer Race |
| 91030 | 163000 | Oil Seal, (3.779" O.D., 2.750" I.D.), Unitized |
| RG04-250 | 150945 | Oil Cap Kit, (92125 Cap, 92126 Plug, 9103502 Gasket) |
| 9251513 | 146400 | Drive-in Stud, 5/8" Diameter |
| 95188 | 141600 | 5/8" Flanged Wheel Nut |

8 Bolt, 6.5" Bolt Circle



- Oil Bath hub, 25580 Inner / 2585 Outer Bearing
- Fits Dexter 9K Axles, "Old Style"
- Drum Size: 12 1/4" x 3 3/8"



| Part No. | Ref. No. | Description |
|------------|----------|--|
| 8-232-5UC3 | 123000 | Complete Hub and Drum Assembly (4.56" Pilot) |
| 8-232-5 | 122800 | Hub and Drum Only (4.56" Pilot) |
| 8-286-5UC3 | 122650 | Complete Hub and Drum Assembly (4.75" Pilot) |
| 8-286-5 | 122625 | Hub and Drum Only (4.75" Pilot, MFG 04-15 Thru 10-01-89) |
| 25580 | 130800 | Inner Bearing |
| 2585 | 131200 | Outer Bearing |
| 25520 | 136200 | Inner Race |
| 2520 | 137200 | Outer Race |
| 10-63 | 161225 | Unitized Oil Seal (3.376" O.D., 2.25" I.D.) |
| RG04-230 | 150940 | Oil Cap Kit, (21-35 Cap, 10-45 O |
| 46-52 | 156000 | Oil Hub Plug |
| 7-115 | 145600 | Drive-in Stud, 5/8" Diameter |
| 33-52-1 | 142800 | Wheel Retaining Ring |
| 6-109 | 141000 | 5/8" Cone Wheel Nut |

8 Bolt, 6.5" Bolt Circle

- **Oil Bath Hub, 387A Inner / 25580 Outer Bearing**
- Fits Dexter 9K (after 10/89) and 10K General Duty
- Capacity of 5,000 lbs. per each
- Drum Size: 12 1/4" x 3 3/8"
- Drum Available with ABS exciter ring installed

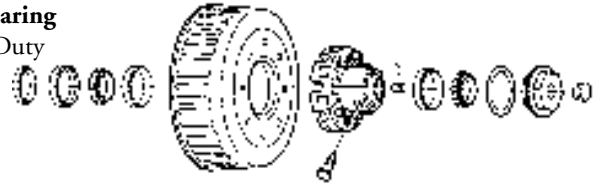

AXLE
COMPONENTS

| Part No. | Ref. No. | Description |
|------------|----------|--|
| 8-288-3UC1 | 111920 | Complete Hub Assembly (does not include brake drum or mtg bolts) |
| 8-288-3 | 111910 | Hub Only |
| 9-44-1 | 124390 | Brake Drum Only, Non-ABS |
| 9-44-3 | 124395 | Brake Drum Only, with ABS exciter ring |
| 7-101 | 150500 | Drum Mounting Bolt |
| 387A | 131400 | Inner Bearing |
| 25580 | 130800 | Outer Bearing |
| 382A | 137400 | Inner Race |
| 25520 | 136200 | Outer Race |
| 10-51 | 161650 | Unitized Oil Seal, (3.88" O.D., 2.875" I.D.) |
| RG04-270 | 150955 | Oil Cap Kit, (21-36 Cap, 10-50 O-Ring, 46-32 Plug) |
| 46-52 | 156000 | Oil Hub Plug |
| 7-115 | 145600 | Drive-in Stud, 5/8" Diameter |
| 33-52-1 | 142800 | Wheel Retaining Ring |
| 6-109 | 141000 | 5/8" Cone Wheel Nut |



8 Bolt, 6.5" Bolt Circle

- **Oil Bath Hub, 395S Inner / 387A Outer Bearing**
- Capacity of 5,000 lbs. per each
- Fits Dexter 10K Axles
- Drum Size: 12 1/4" x 4"
- Drum Available with ABS exciter ring installed



| Part No. | Ref. No. | Description |
|------------|----------|--|
| 8-214-5UC1 | 112200 | Complete Hub Assembly (does not include brake drum or mtg bolts) |
| 8-214-5 | 112000 | Hub Only |
| 9-27-1 | 124400 | Brake Drum Only, Non-ABS |
| 9-27-3 | 124405 | Brake Drum Only, with ABS exciter ring |
| 7-103 | 150600 | Drum Mounting Bolt |
| 395S | 131600 | Inner Bearing |
| 387A | 131400 | Outer Bearing |
| 394A | 137600 | Inner Race |
| 382A | 137400 | Outer Race |
| 10-56 | 162000 | Unitized Oil Seal, (4.50" O.D., 3.125" I.D.) |
| RG04-270 | 150955 | Oil Cap Kit, (21-36 Cap, 10-50 O-Ring, 46-32 Plug) |
| 46-52 | 156000 | Oil Hub Plug |
| 7-115 | 145600 | Drive-in Stud, 5/8" Diameter |
| 33-52-1 | 142800 | Wheel Retaining Ring |
| 6-109 | 141000 | 5/8" Cone Wheel Nut |



8 Bolt, 6.5" Bolt Circle

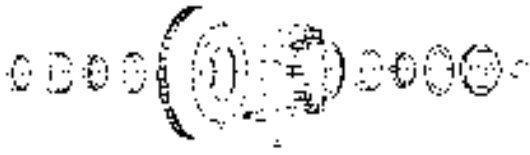

- **Oil Bath hub, 395S Inner / 387A Outer Bearings**
- Capacity of 5,000 lbs. per each
- Fits Dexter 10K Disc Brake Axles
- Rotor Available with ABS exciter ring installed



| Part No. | Ref. No. | Description |
|------------|----------|--|
| 8-214-6UC1 | 112220 | Complete Hub Assembly (does not include rotor or mtg hardware) |
| 8-214-6 | 112210 | Hub Only |
| 70-006 | 124950 | Brake Rotor Only, Non-ABS |
| 70-006-2 | 124955 | Brake Rotor Only, with ABS exciter ring |
| 25-14 | 150825 | Brake Rotor Mounting Stud |
| 6-46 | 193000 | Rotor Mounting Nut |
| 395S | 131600 | Inner Bearing |
| 387A | 131400 | Outer Bearing |
| 394A | 137600 | Inner Race |
| 382A | 137400 | Outer Race |
| 10-56 | 162000 | Unitized Oil Seal, (4.50" O.D., 3.125" I.D.) |
| RG04-270 | 150955 | Oil Cap Kit, (21-36 Cap, 10-50 O-Ring, 46-32 Plug) |
| 46-52 | 156000 | Oil Hub Plug |
| 7-115 | 145600 | Drive-in Stud, 5/8" Diameter |
| 33-52-1 | 142800 | Wheel Retaining Ring |
| 6-109 | 141000 | 5/8" Cone Wheel Nut |

8 Bolt, 6.5" Bolt Circle

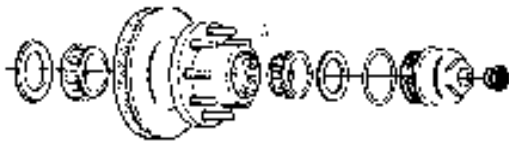

- **Oil Bath Hub, JM11946 Inner / JM205149 Outer Bearing**
- Fits Hayes 10K Disc Brake Axles
- Capacity of 5,000 lbs. per each

| Part No. | Ref. No. | Description |
|-----------|----------|--|
| 090814UC3 | 125200 | Complete Hub & Rotor Assembly |
| 090814 | 125000 | Hub and Rotor Only |
| JM511946 | 132800 | Inner Bearing |
| JM205149 | 132600 | Outer Bearing |
| JM511910 | 138400 | Inner Race |
| JM205110 | 138200 | Outer Race |
| 10-56 | 162000 | Unitized Oil Seal, (4.50" O.D., 3.125" I.D.) |
| RG04-250 | 150945 | Oil Cap Kit, (92125 Cap, 92126 Plug, 92127 O-Ring, 9103502 Gasket) |
| 090737 | 145800 | Drive-in Stud, 5/8" Diameter |
| 95188 | 141600 | 5/8" Flanged Wheel Nut |

8 Bolt, 6.5" Bolt Circle

- **Oil Bath Hub, 3984 Inner / 28682 Outer Bearing**
- Capacity of 6,000 lbs. per each
- Fits Dexter 12K Axles, Hi or Lo-Profile
- Drum Size: 12 1/4" x 5"
- Drum Available with ABS exciter ring installed

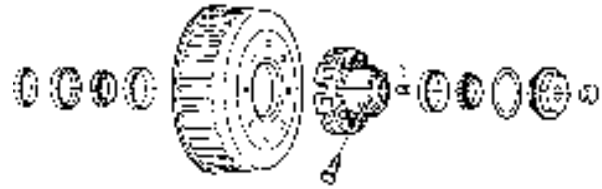

AXLE
COMPONENTS

| Part No. | Ref. No. | Description |
|------------|----------|---|
| 8-214-8UC1 | 113000 | Complete Hub Assembly (16" & 16.5" Diameter Wheels) |
| 8-214-8 | 112800 | Hub Only (16" & 16.5" Diameter Wheels) |
| 8-216-5UC1 | 112600 | Complete Hub Assembly (14.5" Diameter Wheels) |
| 8-216-5 | 112400 | Hub Only (14.5" Diameter Wheels) |
| 9-28-1 | 124600 | Brake Drum Only, Non-ABS |
| 9-28-5 | 124605 | Brake Drum Only, with ABS exciter ring |
| 7-103 | 150600 | Drum Mounting Bolt |
| 3984 | 131800 | Inner Bearing |
| 28682 | 132000 | Outer Bearing |
| 3920 | 138000 | Inner Race |
| 28622 | 137800 | Outer Race |
| 10-56 | 162000 | Unitized Oil Seal, (4.50" O.D., 3.125" I.D.) |
| RG04-270 | 150935 | Oil Cap Kit, (21-36 Cap, 10-50 O-Ring, 46-32 Plug) |
| 46-52 | 156000 | Oil Hub Plug |
| 7-115 | 145600 | Drive-in Stud, 5/8" Diameter |
| 33-52-1 | 142800 | Wheel Retaining Ring |
| 6-109 | 141000 | 5/8" Cone Wheel Nut |



8 Bolt, 6.5" Bolt Circle

- **Oil Bath Hub, 3984 Inner / 28682 Outer Bearing**
- Capacity of 6,000 lbs. per each
- Fits Dexter 12K Disc Brake, Hi-Profile Axles (16" & 16.5" diameter wheels)
- Rotor available with ABS exciter ring installed



| Part No. | Ref. No. | Description |
|-------------|----------|--|
| 8-214-10UC1 | 113020 | Complete Hub Assembly (Does not include Rotor) |
| 8-214-10 | 113010 | Hub Only |
| 70-006 | 124950 | Brake Rotor Only, Non-ABS |
| 70-006-2 | 124955 | Brake Rotor Only, with ABS exciter ring |
| 25-14 | 150825 | Rotor Mounting Bolt |
| 6-46 | 193000 | Rotor Mounting Nut |
| 3984 | 131800 | Inner Bearing |
| 28682 | 132000 | Outer Bearing |
| 3920 | 138000 | Inner Race |
| 28622 | 137800 | Outer Race |
| 10-56 | 162000 | Unitized Oil Seal, (4.50" O.D., 3.125" I.D.) |
| RG04-270 | 150955 | Oil Cap Kit, (21-36 Cap, 10-50 O-Ring, 46-32 Plug) |
| 46-52 | 156000 | Oil Hub Plug |
| 7-115 | 145600 | Drive-in Stud, 5/8" Diameter |
| 33-52-1 | 142800 | Wheel Retaining Ring |
| 6-109 | 141000 | 5/8" Cone Wheel Nut |



8 Bolt, 275mm Bolt Circle (Dual Wheel)

AXLE
COMPONENTS

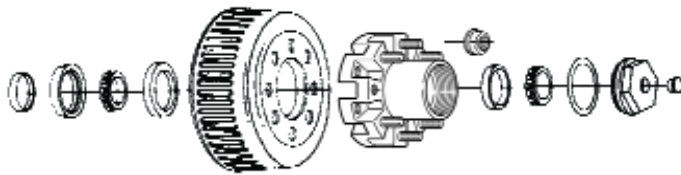

- **Oil Bath Hub, 3984 Inner / 28682 Outer Bearing**
- Capacity of 7,500 lbs. per each
- Fits Dexter 15K Axles, RH & LH Side
- Drum Size: 12 1/4" x 5"
- Drum available with ABS exciter ring installed
- Std stud length, for use w/steel wheels
- Long stud length (Aluminum Wheels) Available



| Part No. | Ref. No. | Description |
|------------|----------|---|
| 8-401-5UC1 | 113075 | Complete Hub Assembly (Does not include Brake Drum) |
| 8-401-5 | 113050 | Hub Only |
| 9-28-1 | 124600 | Brake Drum Only, Non-ABS |
| 9-28-5 | 124605 | Brake Drum Only, with ABS exciter ring |
| 7-103 | 150600 | Drum Mounting Bolt |
| 3984 | 131800 | Inner Bearing |
| 28682 | 132000 | Outer Bearing |
| 3920 | 138000 | Inner Race |
| 28622 | 137800 | Outer Race |
| 10-56 | 162000 | Unitized Oil Seal, (4.50" O.D., 3.125" I.D.) |
| RG04-270 | 150955 | Oil Cap Kit, (21-36 Cap, 10-50 O-Ring, 46-32 Plug) |
| 7-194 | 145325 | Drive-In Stud, Std Length, 22mm X 1.5, 3.94" Long |
| 6-118 | 141700 | Wheel Nut, Swivel-Flange, 22mm, 1-5/16" OD Hex |

10 Bolt, 8.75" Bolt Circle (Dual Wheel)



- **Oil Bath Hub, 3984 Inner / 28682 Outer Bearing**
- Capacity of 7,500 lbs. per each
- Fits Dexter 15K Axles (old style)
- Drum Size: 12 1/4" x 5"
- Drum available with ABS exciter ring installed



| Part No. | Ref. No. | Description |
|-------------|----------|---|
| 8-217-5UC1 | 113400 | Complete Hub Assembly ,RH (Does not include Brake Drum) |
| 8-217-25UC1 | 113800 | Complete Hub Assembly ,LH (Does not include Brake Drum) |
| 8-217-5 | 113200 | Hub Only, RH |
| 8-217-25 | 113600 | Hub Only, LH |
| 9-28-1 | 124600 | Brake Drum Only, Non-ABS |
| 9-28-5 | 124605 | Brake Drum Only, with ABS exciter ring |
| 7-103 | 150600 | Drum Mounting Bolt |
| 3984 | 131800 | Inner Bearing |
| 28682 | 132000 | Outer Bearing |
| 3920 | 138000 | Inner Race |
| 28622 | 137800 | Outer Race |
| 10-56 | 162000 | Unitized Oil Seal, (4.50" O.D., 3.125" I.D.) |
| RG04-270 | 150955 | Oil Cap Kit, (21-36 Cap, 10-50 O-Ring, 46-32 Plug) |
| 46-52 | 156000 | Oil Hub Plug |
| 25-13-1 | 149000 | Screw-in Stud, RH |
| 25-13-2 | 149200 | Screw-in Stud, LH |
| 6-69-1 | 142000 | 13/16" RH Inner Wheel Nut |
| 6-69-2 | 142200 | 13/16" LH Inner Wheel Nut |
| 6-70-1 | 142400 | 1 1/2" RH Outer Wheel Nut |
| 6-70-2 | 142600 | 1 1/2" LH Outer Wheel Nut |