

**Disc Brake: 8 Bolt, 6.5" Bolt Circle**

AXLE  
COMPONENTS

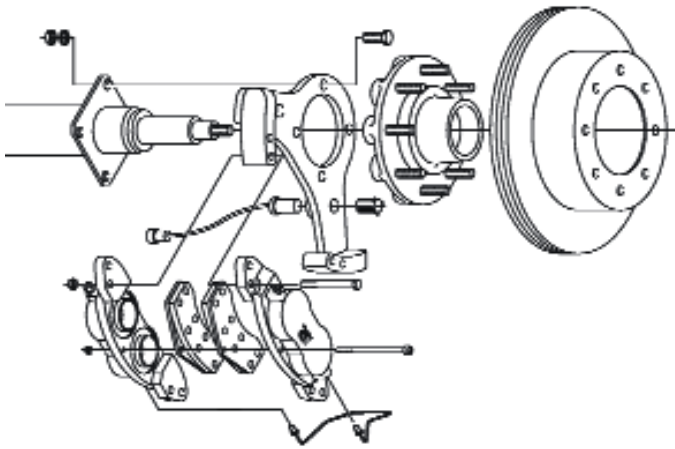

- **25580 Inner / 02475 Outer Bearings & Nev-R-Lube**
- Fits Dexter and most other 8,000lb axles
- Complete Disc Conversion Kits & Components
- Oil Bath, E-Z Lube & Nev-R-Lube Applications
- Two-Piece Hub/Rotor Design
- 9/16" or 5/8" Studs



| Part No.   | Ref. No. | Description   |
|------------|----------|---|
| K71-635*   | 193160   | Dexter 8K Disc Kit, 1 Wheel, less Hub                           |
| 8-399-90** | 193165   | Dexter 8K Disc Hub Kit 9/16" Stud, EZ Lube                      |
| 8-399-91** | 193170   | Dexter 8K Disc Hub Kit 9/16" Stud, Oil Bath                     |
| 8-399-92** | 193175   | Dexter 8K Disc Hub Kit 5/8" Stud, EZ Lube                       |
| 8-399-93** | 193180   | Dexter 8K Disc Hub Kit 5/8" Stud, Oil Bath                      |
| 8-402-80   | 193182   | Dexter 8K Disc Nev-R-Lube Hub w/bearing & retainer, 9/16" Stud  |
| 8-402-81   | 193183   | Dexter 8K Disc Nev-R-Lube Hub w/bearing & retainer, 5/8" Stud   |
| K71-630    | 193218   | Rep'l Caliper, w/caliper bolts (1 wheel) 8K                     |
| K71-631    | 193206   | Rep'l disc rotor, Dex 8K  |
| K71-629    | 193217   | Rep'l disc pad kit, Dex 6K-8K (one axle)                        |
| 31-71-3    | 130875   | Nev-R-Lube Cartridge Bearing, 50mm x 84mm x 54mm                |
| 25580      | 130800   | Inner Bearing   |
| 02475      | 131000   | Outer Bearing   |
| 25520      | 136200   | Inner Race  |
| 02420      | 137000   | Outer Race  |
| 10-63      | 161225   | Unitized Oil Seal (3.376" O.D., 2.25" I.D.)                     |
| 10-36      | 159700   | Grease Seal (3.376" O.D., 2.25" I.D.), for E-Z Lube, Double Lip |
| 21-43-1    | 152400   | Grease Cap, 2.72" O.D., Drive-In, for E-Z Lube                  |
| 85-1       | 155400   | Grease Cap Plug for E-Z Lube                                    |
| RG04-230   | 150940   | Oil Cap Kit (21-35 Cap, 10-45 O-Ring, 46-32 Plug)               |
| 7-257      | 145310   | Drive-in Stud, 9/16" Dia., 2.50" Long                           |
| 7-115      | 145600   | Drive-in Stud, 5/8" Dia., 3.16" Long                            |
| 6-53       | 140800   | 9/16" Cone Wheel Nut  |
| 6-109      | 141000   | 5/8" Cone Wheel Nut   |
| 95188      | 141600   | 5/8" Flange Wheel Nut   |

\* Disc Kit includes 1ea 8K rotor, caliper, disc pads, bracket, & hardware for std grease or E-Z-Lube axle conversions to one side of axle beam.

\*\* Disc hub kits include inner/outer bearing, seal & dust cap.

**Grease Seals, Oil Seals and Wear Sleeves**

AXLE  
COMPONENTS

| Part No.     | Ref. No. | Description                | I.D.  | O.D.  | Use With:                                    |
|--------------|----------|----------------------------|-------|-------|--|
| 34823        | 157800   | SINGLE LIP SEAL            | 1.249 | 1.983 | BT8 SPINDLES                                 |
| 12192TB      | 157805   | DOUBLE LIP SEAL            | 1.249 | 1.983 | BT8 SPINDLES                                 |
| 13194        | 157810   | SINGLE LIP SEAL            | 1.372 | 1.983 | UNIQUE BT HUBS                               |
| 10-9         | 158000   | SINGLE LIP SEAL            | 1.500 | 1.987 | BTR SPINDLES                                 |
| 10-60        | 158200   | DOUBLE LIP SEAL            | 1.500 | 1.987 | E-Z LUBE 2,000 LB                            |
| 1105-100-031 | 158400   | SINGLE LIP SEAL            | 1.750 | 2.356 | 10" HADCO                                    |
| 10-42        | 158600   | SINGLE LIP SEAL            | 1.750 | 2.312 | DEX 2,800 LB AXLES                           |
| 168233       | 158750   | SINGLE LIP SEAL            | 1.688 | 2.332 | UNIQUE #84 HUBS                              |
| 10-40        | 158775   | SINGLE LIP SEAL            | 1.938 | 2.510 | MHU AXLES                                    |
| 58846        | 158800   | SINGLE LIP SEAL            | 1.719 | 2.565 | 3,500 LB AXLES                               |
| 10-19        | 159000   | DOUBLE LIP SEAL            | 1.719 | 2.565 | E-Z LUBE 3,500 LB                            |
| 29031        | 159200   | SINGLE LIP SEAL            | 1.875 | 3.000 | #8 SPINDLE                                   |
| 1105-100-035 | 159400   | SINGLE LIP SEAL            | 2.00  | 2.875 | 12" HADCO                                    |
| 21325        | 159500   | SINGLE LIP SEAL            | 2.125 | 3.269 | UNIQUE #42 HUBS                              |
| 42385        | 159600   | SINGLE LIP SEAL            | 2.250 | 3.376 | #42 SPINDLE                                  |
| 10-36        | 159700   | DOUBLE LIP SEAL            | 2.250 | 3.376 | E-Z LUBE END UNITS                           |
| 10-1         | 159800   | SINGLE LIP SEAL            | 2.125 | 3.375 | DEX 5,200 – 7,000 LB                         |
| 10-10        | 160000   | DOUBLE LIP/ OIL SEAL       | 2.125 | 3.376 | E-Z LUBE & OIL 5,200, 6,000 & 7,000 LB AXLES |
| T51153       | 160200   | SINGLE LIP SEAL            | 2.375 | 3.623 | #99 SPINDLE                                  |
| SL150        | 160400   | SINGLE LIP SEAL            | 1.500 | 2.332 | AGRICULTURAL HUB                             |
| SL175        | 160600   | SINGLE LIP SEAL            | 1.750 | 2.722 | AGRICULTURAL HUB                             |
| SL200        | 160800   | SINGLE LIP SEAL            | 2.000 | 3.066 | AGRICULTURAL HUB                             |
| SL226        | 161000   | SINGLE LIP SEAL            | 2.250 | 3.066 | AGRICULTURAL HUB                             |
| SL275        | 161200   | SINGLE LIP SEAL            | 2.750 | 3.756 | AGRICULTURAL HUB                             |
| 10-63        | 161225   | UNITIZED OIL SEAL          | 2.250 | 3.376 | DEX 8K (&9K 'TIL 10/89)                      |
| 9103309      | 161227   | DOUBLE LIP,<br>DOUBLE CASE | 2.250 | 3.376 | 8K HAYES                                     |
| 10-48        | 161230   | OIL SEAL                   | 2.375 | 3.376 | 60-6 WEAR SLEEVE                             |
| 60-6         | 161235   | WEAR SLEEVE                | 2.250 | 2.375 | 10-48 OIL SEAL                               |
| 10-51        | 161650   | UNITIZED OIL SEAL          | 2.875 | 3.880 | DEX 9K, 10K G.D.                             |
| 10-56        | 162000   | UNITIZED OIL SEAL          | 3.125 | 4.500 | DEX 10K, 12K, 15K & HAYES<br>10K – 12K       |
| 382-8005     | 162410   | OIL SEAL W/ SLEEVE         | 2.775 | 3.671 | INCLUDES 2.671 I.D. WEAR<br>SLEEVE           |
| 10-55-1      | 162800   | UNITIZED OIL SEAL          | 4.625 | 6.000 | 20K – 25K AXLES                              |
| 91030        | 163000   | UNITIZED OIL SEAL          | 2.750 | 3.779 | HAYES #99 SPINDLE                            |



**Grease Seals**

Packaged double lip seals provide extra protection and longer life than standard single lip seals. Two per package.

| Part No. | Ref. No. | Seal    | I.D.   | Interchange # |
|----------|----------|---------|--------|---------------|
| RG06-010 | 157700   | 12192TB | 1.249" | 34823         |
| RG06-020 | 157710   | 10-60   | 1.987" | 10-9          |
| RG06-050 | 157720   | 10-19   | 1.719" | 58846         |
| RG06-070 | 157730   | 10-36   | 2.250" | 42385         |
| RG06-090 | 157740   | 10-10   | 2.125" | 10-1          |



## Grease Caps

AXLE  
COMPONENTS



| Part No. | Ref. No. | Description  | O.D.  |
|----------|----------|--|-------|
| 1527     | 151000   | DRIVE-IN FOR AG HUBS                                 | 1.957 |
| 46749    | 151200   | DRIVE-IN FOR 2K AND 3.5K AXLES                       | 1.986 |
| 21-3-1   | 151400   | DRIVE-IN FOR E-Z LUBE 2K AND 3.5K AXLES              | 1.986 |
| 45896    | 151600   | DRIVE-IN FOR 5.2K AXLES W/ 6 BOLT HUBS               | 2.440 |
| 21-1-1   | 151800   | DRIVE-IN FOR E-Z LUBE 5.2K & 6K AXLES W/ 6 BOLT HUBS | 2.440 |
| 1604     | 152000   | DRIVE-IN FOR AG HUBS                                 | 2.440 |
| 38605    | 152200   | DRIVE-IN FOR 5.2K, 6K & 7K AXLES, & 35MM NEV-R-LUBE  | 2.720 |
| 21-43-1  | 152400   | DRIVE-IN FOR E-Z LUBE 5.2K, 6K & 7K, 8 BOLT AXLES    | 2.720 |
| 1609     | 152600   | DRIVE-IN FOR AG HUBS & 42MM NEV-R-LUBE               | 3.125 |
| 1602     | 152800   | DRIVE-IN FOR VILLAGE 7,000 LB AXLES                  | 3.250 |
| 75DC     | 153000   | DRIVE-IN FOR #99 SPINDLES & 50MM NEV-R-LUBE          | 3.355 |
| 092105   | 153200   | DRIVE-IN FOR HAYES 10,000 AND 12,000 LB AXLES        | 3.625 |

## Grease and Oil Cap Replacement Parts



| Part No. | Ref No. | Description                   | For:                                     |
|----------|---------|-------------------------------|--|
| 21-40    | 153600  | 2.563" O.D., SCREW-IN PLASTIC | 6K, 7K OIL (5 SPOKE) DX                  |
| 21-35    | 153800  | 2.875" O.D., SCREW-IN PLASTIC | 6K - 8K (& 9K PRIOR 10/89) DX            |
| 21-36    | 153975  | 4.00" O.D., SCREW IN PLASTIC  | 9K (AFTER 10/89), 10K GD, 10K - 15K DX   |
| 92128    | 154100  | OIL CAP ONLY                  | 7K-8K HAYES/ALKO NEW STYLE (AFTER 01/97) |
| 9212801  | 154150  | OIL CAP ONLY                  | 7K-8K HAYES (PRIOR TO 01/97)             |
| 92125    | 154200  | 3.750" O.D., SCREW-IN         | 10K, 12K HAYES / ALKO                    |
| 85-1     | 155400  | GREASE CAP PLUG               | ALL E-Z GREASE CAPS                      |
| 46-32    | 155600  | OIL CAP PLUG                  | 21-35, 21-36, 21-37 CAPS                 |
| 92126    | 155800  | OIL CAP PLUG                  | 92125, 340-4009, 340-4139, 92128         |
| 46-52    | 156000  | OIL HUB PLUG                  | 8K - 15K DEXTER OIL HUBS                 |
| 10-45    | 156600  | OIL CAP O-RING                | 21-35 OIL CAP                            |
| 10-50    | 156800  | OIL CAP O-RING                | 21-36 CAP                                |
| 10-59    | 156825  | OIL CAP O-RING                | 21-40 OIL CAP                            |
| 92127    | 157000  | OIL CAP O-RING                | 92125 OIL CAP                            |
| 9103501  | 153985  | OIL CAP GASKET                | 92128 & 9212801                          |
| 9103502  | 153990  | OIL CAP GASKET                | 92125 (USE W/ 92127 O-RING)              |

## Bolt-On Oil Caps



| Part No. | Ref. No. | Description                                       |
|----------|----------|---|
| 340-4139 | 157400   | OIL CAP, 6 ON 4.06" BOLT, FOR HAYES 10K OLD STYLE |
| 340-4009 | 157600   | OIL CAP, 6 ON 5 1/2" BOLT, FOR 20K - 25K AXLES    |

## Packaged Grease Caps

Protect bearings from contamination with packaged grease caps. Two caps per package.



AXLE  
COMPONENTS

| Part No. | Ref. No. | Description                              |
|----------|----------|--|
| RG04-010 | 150900   | PLUG ONLY FOR EZ LUBE GREASE CAPS        |
| RG04-020 | 150905   | 1.986" O.D., DRIVE IN                    |
| RG04-040 | 150910   | 1.986" O.D., DRIVE IN W/PLUG FOR EZ LUBE |
| RG04-060 | 150915   | 2.44" O.D., DRIVE IN                     |
| RG04-080 | 150920   | 2.44" O.D., DRIVE IN W/PLUG FOR EZ LUBE  |
| RG04-100 | 150925   | 2.72" DRIVE IN                           |
| RG04-120 | 150930   | 2.72" DRIVE IN W/PLUG FOR EZ LUBE        |

## Complete Oil Cap Kits



| Part No. | Ref. No. | Description   | Fits:                                    |
|----------|----------|---|--|
| RG04-230 | 150940   | 21-35 OIL CAP, 10-45 O-RING, 46-32 PLUG                 | 6K, 7K, 8K, 9K AXLES (8 BOLT) DEXTER     |
| RG04-250 | 150945   | 92125 OIL CAP, 92127 O-RING, 9103502 GASKET, 92126 PLUG | 10K, 12K HAYES / ALKO                    |
| RG04-260 | 150950   | 21-40 OIL CAP, 10-59 O-RING                             | 6K, 7K, OIL BATH HUB AND DRUMS (5 SPOKE) |
| RG04-270 | 150955   | 21-36 OIL CAP, 10-50 O-RING, 46-32 PLUG                 | 9K (AFTER 10/89) AND 10K GENERAL DUTY    |
| RG04-280 | 150960   | 92128 OIL CAP, 9103501 GASKET, 92126 PLUG               | 8K HAYES / ALKO (AFTER 01/97)            |
| RG04-290 | 150965   | 9212801 OIL CAP, 9103501 GASKET, 92126 PLUG             | 8K HAYES / ALKO (PRIOR 01/97)            |

## Bearing Protectors

Bearing Protectors keep grease inside the hub and water out! An overload outlet allows grease to escape if the hub is overfilled or excessive pressure is built up. Outer diameter is 1.980, fits hubs with L44610 outer race. Chrome plated metal alloy construction. The Bearing Protector Cover keeps the excess grease from being thrown on the wheels while trailering.



| Part No. | Ref. No. | Description   |
|----------|----------|---|
| BL1980   | 413800   | 1 EACH BEARING PROTECTOR, FOR HUBS W/L44643 OR L44649 |
| BLB1     | 414000   | ONE EACH, BEARING PROTECTOR BRA, USE WITH ABOVE       |
| RG07-040 | 414001   | PKGD 1.98" BEARING PROTECTORS & COVERS, 1 PAIR        |

See Pages B-39 thru B-40 for unpackaged items.