

## Replacement Bearings

Replacement Bearings are high quality tapered roller bearings, designed for high-speed use. All bearings have industry standard numbers, regardless of the brand. Inner dimension of bearing is included for your convenience.



Part No.	Ref. No.	Description	I.D.
L44643	128800	INNER / OUTER FOR BT8	1.000
L44649	129000	INNER / OUTER FOR BTR, OUTER FOR #84 SPINDLES	1.063
L68149	129200	INNER FOR #84 SPINDLES	1.378
1779	129400	OUTER FOR 22834 HUB	0.938
2788	129600	INNER FOR 22834 HUB	1.500
LM48548	129800	INNER FOR AH25555F AGRICULTURAL HUB	1.375
LM67048	130000	OUTER FOR 8-201-5, 8-213-5	1.250
15123	130400	OUTER FOR 42655, 42656, 8-174-5	1.250
14125A	130600	OUTER FOR 42865, 42866, 8-219-4, 8-231-9	1.250
25580	130800	#42, 8K, 9K INNER (PRE 10/89), OUTER FOR #99	1.750
31-71-3	130875	50MM CARTRIDGE STYLE, NEV-R-LUBE	50MM
31-72-3	130875	35MM CARTRIDGE STYLE, NEV-R-LUBE	35MM
31-73-3	130900	42MM CARTRIDGE STYLE, NEV-R-LUBE	42MM
02475	131000	OUTER FOR 8-231-8, 8-218-9, 8-187-7	1.250
2585	131200	OUTER FOR 8-232-5	1.313
387A	131400	OUTER FOR 8-214-5, INNER FOR 8-260-5	2.250
395S	131600	INNER FOR 8-214-5	2.625
3984	131800	INNER FOR 8-216-5, 8-214-8, 8-217-5, 8-272-5	2.625
28682	132000	OUTER FOR 8-216-5, 8-214-8, 8-217-5, 8-727-5	2.250
28580	132200	INNER FOR ALL #99 SPINDLES	2.000
JM205149	132600	FOR 090814 HAYES 10K	1.969
JM511946	132800	FOR 090814 HAYES 10K	2.559
HM212049	133000	OUTER FOR 20K – 25K AXLES	2.625
HM218248	133100	INNER FOR 20K – 25K AXLES	3.542
LM11949	133200	OUTER FOR AH15450E AGRICULTURAL HUB	0.750
29749	133600	FOR AH30660F AGRICULTURAL HUB	1.500
501349	133800	OUTER FOR AH60880F, INNER FOR AH35660F	1.625
506849	134000	FOR AH60880F AGRICULTURAL HUB	2.165
603049	134200	FOR AH45880F AGRICULTURAL HUB	1.781

## Wheel Bearing Kits



**Makes Bearing Replacements Easier and Quicker!  
One Kit Per Wheel Required!**

**Wheel Bearing Kits are available for:**

- Applications ranging from the BT8 1" spindle to 7,000 lb. spindles
- All kits include: Double Lip Grease Seals, allowing kits to be used with standard or E-Z Lube Spindles.

**Each Wheel Bearing Kit includes:**

- One Inner Bearing and Race
- One Outer Bearing and Race
- Grease Seal
- Cotter Pin

Part No.	Ref. No.	Outer Bearing	Inner Bearing	Seal	Seal I.D.
BK1-100	128611	L44643	L44643	12192TB	1.249"
BK1-150	128621	L44649	L44649	10-60	1.500"
BK2-100	128641	L44649	L68149	10-19	1.719"
BK3-100	128662	15123	25580	10-36	2.250"
BK3-110	128664	15123	25580	10-10	2.125"
BK3-200	128684	14125A	25580	10-36	2.250"
BK3-210	128686	14125A	25580	10-10	2.125"
BK3-300	128704	LM67048	25580	10-36	2.250"
BK3-310	128706	LM67048	25580	10-10	2.125"



AXLE  
COMPONENTS

## Replacement Races

Part No.	Ref. No.	Description	O.D.
L44610	134400	FOR L44643, L44649 BEARING	1.980
1729	134600	FOR 1779 BEARING	2.240
2729	134800	FOR 2788 BEARING	3.000
L68111	135000	FOR L68149 BEARING	2.362
LM48510	135200	FOR LM48548 BEARING	2.563
LM67010	135400	FOR LM67048 BEARING	2.328
15245	135600	FOR 15123 BEARING	2.441
14276	135800	FOR 14125A BEARING	2.717
25520	136200	FOR 25580 BEARING	3.265
28521	136800	FOR 28580 BEARING	2.875
02420	137000	FOR 02475 BEARING	2.688
2520	137200	FOR 2585 BEARING	2.750
382A	137400	FOR 287A BEARING	3.813
394A	137600	FOR 395S BEARING	4.331
28622	137800	FOR 28682 BEARING	3.844
3920	138000	FOR 3984 BEARING	4.438
JM205110	138200	FOR JM205149 BEARING	3.543
JM511910	138400	FOR JM511946 BEARING	4.331
HM212011	138600	FOR HM212049 BEARING	4.813
HM218210	138800	FOR HM218248 BEARING	5.786
LM11910	139000	FOR LM11949 BEARING	1.781
29710	139200	FOR 29749 BEARING	2.563
501310	139400	FOR 501349 BEARING	2.891
506810	139600	FOR 506849 BEARING	3.543
603011	139800	FOR 603049 BEARING	3.063



## Wheel Studs - Drive In

Dimensions are as follows:

A=Thread Diameter, B=Stud Length, C=Spline Length, D=Base Length, E= Spline Diameter.

AXLE  
COMPONENTS

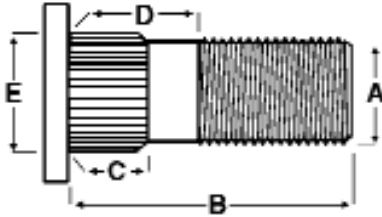

Part No.	Ref. No.	Thread Dia.	Length	Spline Length	Base Length	Spline Dia
LB169	144425	1/2"	1-11/64"	0.38	0.52	0.545
165981	144400	1/2"	1 1/2"	0.25	0.65	0.62
7-122	144600	1/2"	1 13/16"	0.62	0.73	0.61
09251510	144750	1/2"	1 7/8"	0.26	0.52	0.54
LB2.0	144775	1/2"	2"	0.38	0.52	0.545
7-150	144800	1/2"	2-3/32"	0.62	0.73	0.61
166013	144900	1/2"	2 3/8"	0.65	0.85	0.61
165995	145000	1/2"	2 1/2"	0.68	1.38	0.54
7-223	145300	9/16"	2"	0.58	0.75	0.69
7-257	145310	9/16"	2-1/2"	0.31	0.81	0.689
LB2.5	145320	9/16"	2-1/2"	0.5	1.075	0.618
7-224	145350	5/8"	2 1/2"	0.71	1.15	0.69
7-232	145400	5/8"	2 3/4"	0.83	1.03	0.69
1660151	146000	5/8"	2 3/4"	0.79	0.97	0.65
090737	145800	5/8"	2 13/16"	0.58	0.8	0.68
7-115	145600	5/8"	3 1/8"	1.02	1.39	0.69
9251513	146400	5/8"	3 1/4"	0.58	1.45	0.66
7-194	145325	M22 x 1.5	3-15/16"	0.5	0.72	0.97

## Wheel Studs - Screw In

Screw-in studs are threaded on both ends. Dimensions are as follows:

A=Thread Diameter, B= Overall Length, C=Lug Nut End Length, D= Hub End Length.

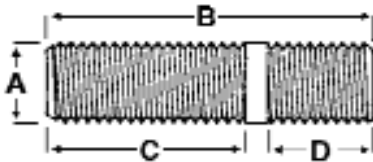

Part No.	Ref. No.	A	B	C	D
25-53	147800	1/2"	2"	1 1/6" FINE	1 3/16" FINE
25-51	148000	1/2"	2"	7/8" FINE	5/8" COARSE
25-11	148200	9/16"	3"	1 9/16" FINE	3/4" COARSE
25-48	148800	5/8"	3"	1 9/16" FINE	1" COARSE
25-13-1	149000	3/4"	2 1/2" RH	1" FINE	1 1/4" COARSE
25-13-2	149200	3/4"	2 1/2" LH	1" FINE	1 1/4" COARSE
25-55	149400	3/4"	3"	1" COARSE	1 3/4" COARSE

## Wheel Bolts

Use the following table to choose the correct wheel bolt. Dimensions are as follows:

A=Thread Diameter, B=Thread Length, C= Head Size.

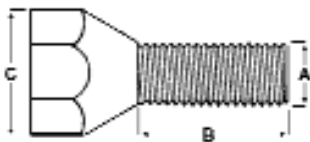

Part No.	Ref. No.	A	B	C	Description
X1064	143200	1/2"	7/8"	1 3/16"	FINE THREAD, 60 DEGREE CONED
LB509	143300	1/2"	7/8"	1 3/16"	FINE THREAD, 90 DEGREE CONED
LB569	143400	9/16"	1 1/8"	7/8"	FINE THREAD, 90 DEGREE CONED
090753	143600	1/2"	1 5/8"	7/8"	COARSE THREAD, FLAT HEAD
090702	143800	1/2"	1 7/8"	7/8"	FINE THREAD, FLAT HEAD
7-23	144000	1/2"	2 1/4"	7/8"	COARSE THREAD, FLAT HEAD

## Packaged Wheel Bolts & Studs

Part No.	Ref. No.	Description
RG02-020	142900	WHEEL BOLT, 1/2" DIAMETER, 13/16" HEAD, 1" LONG, 60 DEGREE, (QTY 4)
RG02-040	142910	WHEEL BOLT, 1/2" DIAMETER, 13/16" HEAD, 7/8" LONG, 90 DEGREE, (QTY 4)
RG02-060	142920	WHEEL BOLT, 9/16" DIAMETER, 7/8" HEAD, 1-1/8" LONG, 90 DEGREE, (QTY 4)
RG03-020	144100	DRIVE-IN STUD, 1/2" DIAMETER, 1-1/2" LONG (QTY 4)
RG03-040	144110	DRIVE-IN STUD, 1/2" DIAMETER, 1-13/16" LONG (QTY 4)
RG03-060	144120	DRIVE-IN STUD, 1/2" DIAMETER, 1-7/8" LONG (QTY 4)
RG03-080	144130	DRIVE-IN STUD, 1/2" DIAMETER, 2-1/2" LONG (QTY 4)
RG03-120	144140	DRIVE-IN STUD, 5/8" DIAMETER, 3-1/8" LONG (QTY 4)
RG03-140	144150	DRIVE-IN STUD, 5/8" DIAMETER, 2-13/16" LONG (QTY 4)



AXLE  
COMPONENTS

## Wheel Nuts

Part No.	Ref. No.	Description	O.D.
916N	078400	9/16" HEXNUT RH, USE W/15-2 CLAMP	7/8"
STN569	140200	9/16" HEX WHEEL RH, 90 DEGREE CONED	1"
6-117	140450	3/4" HEX RIM NUT RH, USE W/ 15-13-1 OR 15-15-1 CLAMP	1-1/4"
N10R	140500	7/16" CONE WHEEL NUT RH, 60 DEGREE CONED	3/4"
X1023R	140600	1/2" CONE WHEEL NUT RH, 60 DEGREE CONED	13/16"
6-53	140800	9/16" CONE WHEEL NUT RH, 60 DEGREE CONED	7/16"
6-109	141000	5/8" CONE WHEEL NUT RH, 90 DEGREE CONED	1-1/16"
X1148	141200	5/8" CONE WHEEL NUT RH, 90 DEGREE CONED	15/16"
X1149	141400	5/8" CONE WHEEL NUT LH, 90 DEGREE CONED	15/16"
95188	141600	5/8" FLANGED WHEEL NUT RH	1-1/8"
6-69-1	142000	WHEEL NUT, RH INNER BUDD TYPE	1-3/16"
6-69-2	142200	WHEEL NUT, LH INNER BUDD TYPE	1-3/16"
6-70-1	142400	WHEEL NUT, RH OUTER BUDD TYPE	1-1/2"
6-70-2	142600	WHEEL NUT, LH OUTER BUDD TYPE	1-1/2"
33-52-1	142800	WHL RETAINING RING 9K-12K USE W/6-109 NUTS	N/A
6-118	141700	M22 X 1.5 WHEELNUT, SWIVEL-FLANGE	1-5/16"



## Rim Clamps

Part No.	Ref. No.	Description	Use With:
15-2	149600	RIM CLAMP, UTG & MH STYLE	14.5" SINGLE RIMS



## Packaged Rim Clamps and Wheel Nuts

Part No.	Ref. No.	Description
RG01-020	139900	RIM CLAM FOR MOBILE HOME & UTILITY 14.5" RIMS,(QTY 5)
RG01-040	139910	9/16" X 7/8" HEX WHEEL NUT RH THREAD (QTY 5)
RG01-060	139920	1/2" X 13/16" CONE WHEEL NUT RH THREAD, 60 DEGREE CONED, (QTY 5)
RG01-080	139930	9/16" X 7/8" CONE WHEEL NUT RH THREAD, 60 DEGREE CONED, (QTY 4)
RG01-100	139940	5/8" X 1-1/16" CONE WHEEL NUT RH THREAD, 90 DEGREE CONED, (QTY 4)
RG01-120	139950	5/8" X 1-1/8" FLANGED WHL NUT, RH THREAD (QTY 4)
RG01-150	139980	1/2" WHEEL LOCK SET, INCLUDES 2 LOCKS & 1 KEY



**Boxed Hub Assemblies**

AXLE  
COMPONENTS



Each Kit Contains:

- Hub with pressed in Race and Studs
- Bearings
- Grease Cap
- Grease Seal

Part No.	Ref. No.	Bolt Pattern	Outer Bearing	Inner Bearing	Seal	Fits Spindle
34822BX	105410	4 on 4"	L44643	L44643	34823	BT8
34822545BX	106210	5 on 4.5"	L44643	L44643	34823	BT8
84545BX	107010	5 on 4.5"	L44649	L68149	58846	#84
84550BX	107810	5 on 5"	L44649	L68149	58846	#84

**Running Gear Replacement Parts**

*The Most Commonly Asked For Running Gear Parts in Attractive Showroom Packaging!*

**Designed for *Your* Retail Sales...**

Convenient Redline assortments simplify product selection and display set up in your retail showroom. Each assortment includes a selection of the best selling products in each category, a shelf header card and a plan-o-gram to help with product placement.



*Included in Assortment*

Part No.	Description	Qty
84545BX	BOXED HUB KIT 84545 HUB	4
BK1-100	BEARING KIT FOR 1" BT8 SPINDLE	4
BK1-150	BEARING KIT, 1.125" BTR SPINDLE	4
BK2-100	BEARING KIT FOR #84SPINDLE	4
RG01-020	RIM CLAMP, MOBILE HOME & UTILITY 14.5" RIMS (5/PKG)	4
RG01-060	1/2" X 13/16" CONE WHL NUT RH THREAD (5/PKG)	4
RG02-020	WHLBOLT, 1/2" DIA, 13/16" HEAD, 1' 'LONG, 60 DEGREE (4/PKG)	4
RG02-040	WHLBOLT, 1/2" DIA, 13/16" HEAD, 7/8" LONG, 90 DEGREE (4/PKG)	4
RG02-060	WHLBOLT, 9/16" DIA, 7/8" HEAD, 1-1/8" LONG, 90 DEGREE (4/PKG)	4
RG03-040	DRIVE IN STUD, 1/2" DIA, 1-13/16" LGTH (4/PKG)	4
RG03-060	DRIVE IN STUD, 1/2" DIA, 1-7/8" LGTH (4/PKG)	4
RG03-080	DRIVE IN STUD, 1/2" DIA, 2-1/2" LGTH (4/PKG)	4
RG04-020	GREASE CAP 1.986" O.D. (2/PKG)	4
RG04-060	GREASE CAP 2.44" O.D. (2/PKG)	2
RG04-100	GREASE CAP, 2.75" O.D. (2/PKG)	2
RG05-020	1"-14 SPINDLE NUT, TONGUE WASHER, COTTER PIN, (2/PKG)	4
RG05-040	1"-14 SPINDLE NUT, D-WASHER, COTTER PIN, (2/PKG)	4
RG05-060	1"-14 SPINDLE NUT, TANG & D-WASHER, (2/PKG)	4
RG06-010	12192TB GREASE SEALS (2/PKG)	4
RG06-050	10-19 DOUBLE LIP SEALS (2/PKG)	4
RG06-070	10-36 DOUBLE LIP SEALS (2/PKG)	3

Part No. RGP-ASST

Ref No. 497420

*Call Your Nearest Redneck Branch For Details!*